

# HONEYVILLE CITY PUBLIC WORKS CONSTRUCTION STANDARDS



## Standard Drawing Index

- SHEET 1 - STREET IMPROVEMENT DETAILS - 60' RURAL CLASSIFICATION**
- SHEET 2 - STREET IMPROVEMENT DETAILS - 66' RURAL COLLECTOR ROAD CLASSIFICATION**
- SHEET 3 - STREET IMPROVEMENT DETAILS - URBAN CLASSIFICATION**
- SHEET 4 - STREET ADDRESS AND STOP SIGN & POST DETAIL**
- SHEET 5 - TYPICAL DRIVEWAY DETAIL - URBAN CLASSIFICATION ONLY**
- SHEET 6 - TYPICAL HANDICAP RAMP - URBAN CLASSIFICATION ONLY**
- SHEET 7 - TYPICAL STREET INTERSECTION - URBAN CLASSIFICATION ONLY**
- SHEET 8 - TYPICAL STREET INTERSECTION - RURAL CLASSIFICATION**
- SHEET 9 - TYPICAL CUL-DE-SAC DETAIL - URBAN CLASSIFICATION ONLY**
- SHEET 10 - TYPICAL CUL-DE-SAC DETAIL - RURAL CLASSIFICATION**
- SHEET 11 - STORM DRAIN DETAILS**
- SHEET 12 - CULINARY WATER SYSTEM STANDARD DETAILS**
- SHEET 13 - LARGE DIAMETER SERVICE METER DETAILS**

**RECOMMENDED:**

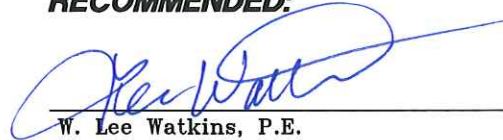
  
 W. Lee Watkins, P.E. 1-26-09  
 Date

  
 HONEYVILLE CITY PLANNING  
 COMMISSION CHAIRMAN 2-25-09  
 Date

**APPROVAL:**

  
 Ellen Cook - HONEYVILLE CITY MAYOR 2-25-09  
 Date

  
 Emily Ketsdever - HONEYVILLE CITY CLERK 2-25-09  
 Date

**PUBLIC WORKS CONSTRUCTION SPECIFICATIONS:**

WHERE APPLICABLE, AND UNLESS OTHERWISE SPECIFIED, CONSTRUCTION OF PUBLIC WORKS FACILITIES AND INFRASTRUCTURE SHALL COMPLY WITH THE LATEST EDITION OF THE AMERICAN PUBLIC WORKS ASSOCIATION MANUAL OF STANDARD SPECIFICATIONS WHICH ARE ADOPTED BY REFERENCE AS A COMPANION DOCUMENT TO THESE DRAWINGS. RESOLUTION OF ANY INCONSISTENCIES BETWEEN THESE DRAWINGS AND THE ADOPTED SPECIFICATIONS WILL BE MADE BY THE CITY ENGINEER.

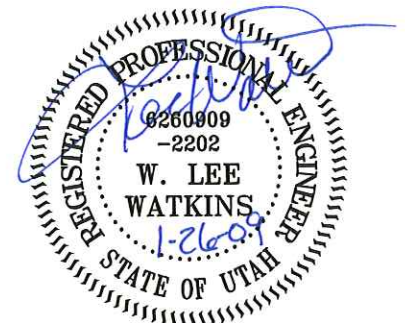

**HANSEN & ASSOCIATES, INC.**  
 Consulting Engineers and Land Surveyors  
 538 North Main Brigham City, Utah 84302  
 Brigham City Ogden Logan  
 725-3491 399-4905 752-8272



\* ROADS AND ROADSIDE DRAINAGE SWALES SHALL BE DESIGNED TO SLOPE AT A MINIMUM OF 0.5% TOWARD DRAINAGE OUTLET. ADJACENT LOT OWNERS TO MAINTAIN DRAINAGE SWALES WITH ROCK LINING, OF THE SIZE AND TYPE APPROVED BY HONEYVILLE CITY, OR WITH LANDSCAPE SOD, OR A COMBINATION THEREOF, FROM THE PROPERTY LINE TO THE EDGE OF THE GRAVEL SHOULDER. LANDSCAPE BOULDERS ARE DISALLOWED. GEOMETRY OF DRAINAGE SWALES SHALL BE PRESERVED BY LOT OWNERS AS SHOWN HEREON. ANY MODIFICATION OF SWALE GEOMETRY OR FILLING IN OF SWALES IS PROHIBITED WITHOUT HONEYVILLE CITY PERMISSION. ROCK LINING OR SOD LANDSCAPING OF THE DRAINAGE SWALES SHALL BE COMPLETED WITHIN ONE YEAR FROM THE DATE OF THE OCCUPANCY PERMIT. HONEYVILLE CITY INSPECTION DEPARTMENT SHALL REQUIRE A DEPOSIT WHEN BUILDING PERMITS ARE ISSUED FOR DWELLINGS TO GUARANTEE COMPLETION OF THE SWALES BY THE LOT OWNER.

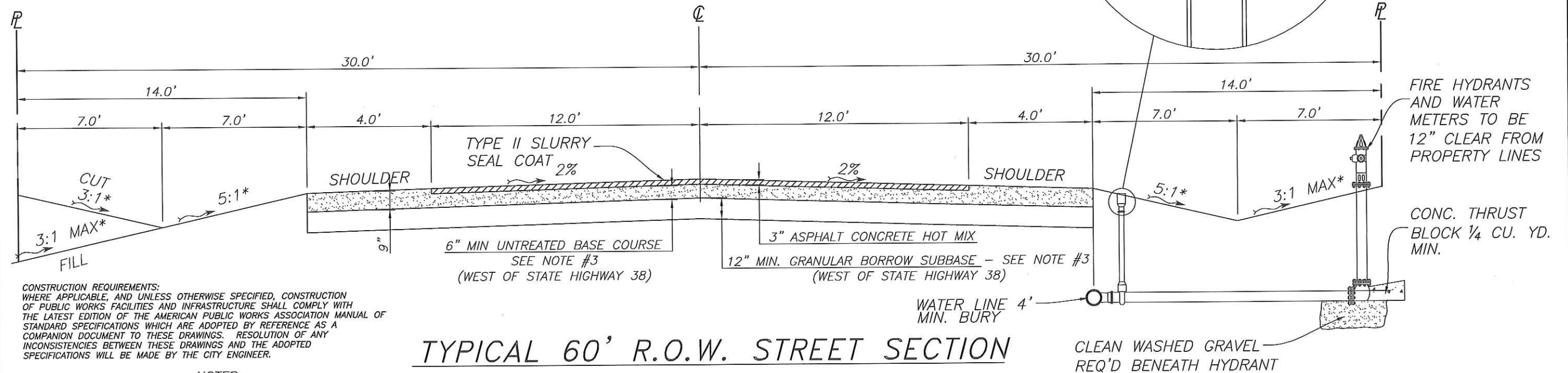
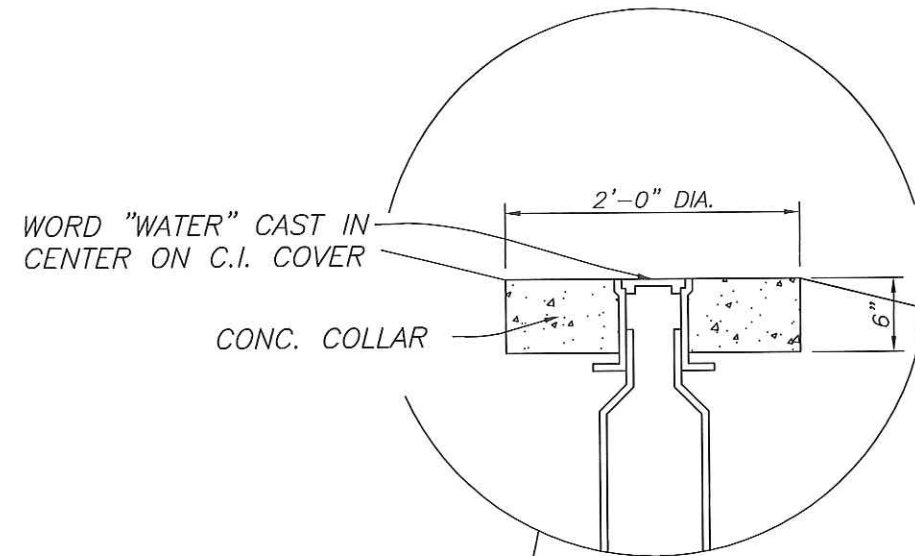

### TYPICAL 60' R.O.W. STREET SECTION

CONSTRUCTION REQUIREMENTS: WHERE APPLICABLE, AND UNLESS OTHERWISE SPECIFIED, CONSTRUCTION OF PUBLIC WORKS FACILITIES AND INFRASTRUCTURE SHALL COMPLY WITH THE LATEST EDITION OF THE AMERICAN PUBLIC WORKS ASSOCIATION MANUAL OF STANDARD SPECIFICATIONS WHICH ARE ADOPTED BY REFERENCE AS A COMPANION DOCUMENT TO THESE DRAWINGS. RESOLUTION OF ANY INCONSISTENCIES BETWEEN THESE DRAWINGS AND THE ADOPTED SPECIFICATIONS WILL BE MADE BY THE CITY ENGINEER.

NOTES:

- 1 - THIS DRAWING IS NOT TO VERTICAL SCALE. VERTICAL FEATURES ARE EXAGGERATED FOR DRAWING CLARITY.
- 2 - ALL WATER VALVES ARE TO BE FINISHED WITH CONCRETE COLLARS AT THE SURFACE.
- 3 - THE GRANULAR BORROW, CRUSHED GRAVEL, AND ASPHALT THICKNESSES SHOWN ARE CONSIDERED AS CITY MINIMUM STANDARDS FOR ALL AREAS WEST OF STATE HIGHWAY 38. DUE TO CHARACTERISTICS OF GRANULAR NATIVE SOILS MANY AREAS EAST OF STATE HIGHWAY 38 MAY BE REDUCED TO 0-INCHES OF GRANULAR BORROW, 8-INCHES OF CRUSHED GRAVEL, AND 3-INCHES OF ASPHALT CONCRETE HOT MIX. AREAS EAST OF STATE HIGHWAY 38 WILL BE CONSIDERED ON A CASE BY CASE BASIS. GEOTECHNICAL SOILS STUDIES ARE REQUIRED FOR ALL NEW PROPOSED ROADS TO VERIFY THE APPROPRIATE THICKNESSES SHOWN AND DESCRIBED HEREON ARE ADEQUATE FOR THE PROPOSED SERVICE THE NEW ROADS WILL PROVIDE. IF THE NEW ROADS ARE PROPOSED AS PART OF OR WITHIN A NEW DEVELOPMENT OR SUBDIVISION, THE DEVELOPER OR SUBDIVIDER IS RESPONSIBLE FOR THE COST OF FURNISHING THE GEOTECHNICAL SOIL REPORT TO HONEYVILLE CITY FOR REVIEW BY THE CITY ENGINEER.
- 4 - USE GRADE 1 1/2 FOR UNTREATED BASE COURSE.
- 5 - USE GRANULAR BORROW PER SECTION 02055 OF APWA STANDARD SPECIFICATIONS FOR SUB BASE.
- 6 - USE GRADE DM - 3/4 FOR ASPHALT CONCRETE HOT MIX.

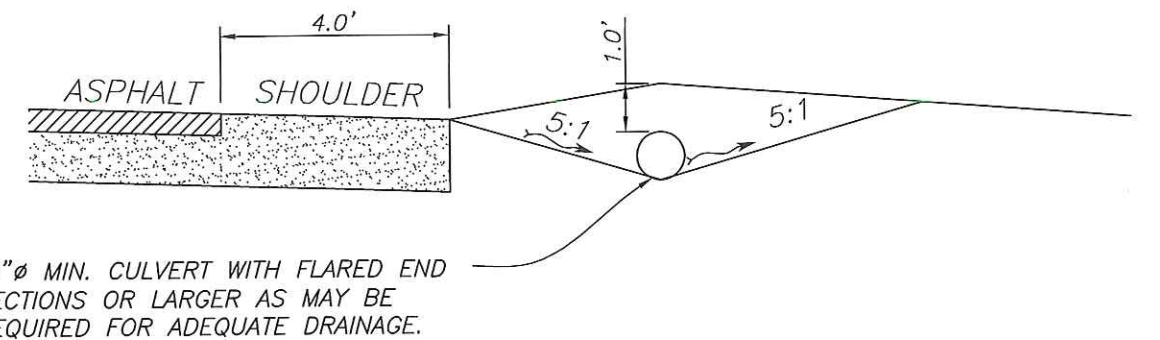

### TYPICAL DRIVEWAY DETAIL

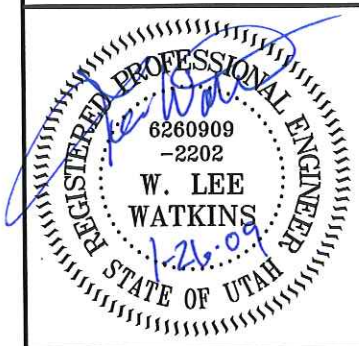

APPROVED  
  
 CITY CONSULTING ENGINEER DATE 1-26-09  
 HONEYVILLE CITY MAYOR DATE

HANSEN & ASSOCIATES, INC.  
 Consulting Engineers and Land Surveyors  
 538 North Main Brigham City, Utah 84302  
 Brigham City Ogden Logan  
 723-3491 399-4905 752-8272

REVISION DATE:  
 DATE: 1/23/09  
 SCALE: NONE

HONEYVILLE CITY  
 PUBLIC WORKS CONSTRUCTION STANDARDS  
**STREET IMPROVEMENT DETAILS**  
**60' RURAL CLASSIFICATION**

SHEET:  
**1**  
 OF 13 SHEETS



\* ROADS AND ROADSIDE DRAINAGE SWALES SHALL BE DESIGNED TO SLOPE AT A MINIMUM OF 0.5% TOWARD DRAINAGE OUTLET. ADJACENT LOT OWNERS TO MAINTAIN DRAINAGE SWALES WITH ROCK LINING, OF THE SIZE AND TYPE APPROVED BY HONEYVILLE CITY, OR WITH LANDSCAPE SOD, OR A COMBINATION THEREOF, FROM THE PROPERTY LINE TO THE EDGE OF THE GRAVEL SHOULDER. LANDSCAPE BOULDERS ARE DISALLOWED. GEOMETRY OF DRAINAGE SWALES SHALL BE PRESERVED BY LOT OWNERS AS SHOWN HEREON. ANY MODIFICATION OF SWALE GEOMETRY OR FILLING IN OF SWALES IS PROHIBITED WITHOUT HONEYVILLE CITY PERMISSION. ROCK LINING OR SOD LANDSCAPING OF THE DRAINAGE SWALES SHALL BE COMPLETED WITHIN ONE YEAR FROM THE DATE OF THE OCCUPANCY PERMIT. HONEYVILLE CITY INSPECTION DEPARTMENT SHALL REQUIRE A DEPOSIT WHEN BUILDING PERMITS ARE ISSUED FOR DWELLINGS TO GUARANTEE COMPLETION OF THE SWALES BY THE LOT OWNER.

CONSTRUCTION REQUIREMENTS:  
WHERE APPLICABLE, AND UNLESS OTHERWISE SPECIFIED, CONSTRUCTION OF PUBLIC WORKS FACILITIES AND INFRASTRUCTURE SHALL COMPLY WITH THE LATEST EDITION OF THE AMERICAN PUBLIC WORKS ASSOCIATION MANUAL OF STANDARD SPECIFICATIONS WHICH ARE ADOPTED BY REFERENCE AS A COMPANION DOCUMENT TO THESE DRAWINGS. RESOLUTION OF ANY INCONSISTENCIES BETWEEN THESE DRAWINGS AND THE ADOPTED SPECIFICATIONS WILL BE MADE BY THE CITY ENGINEER.

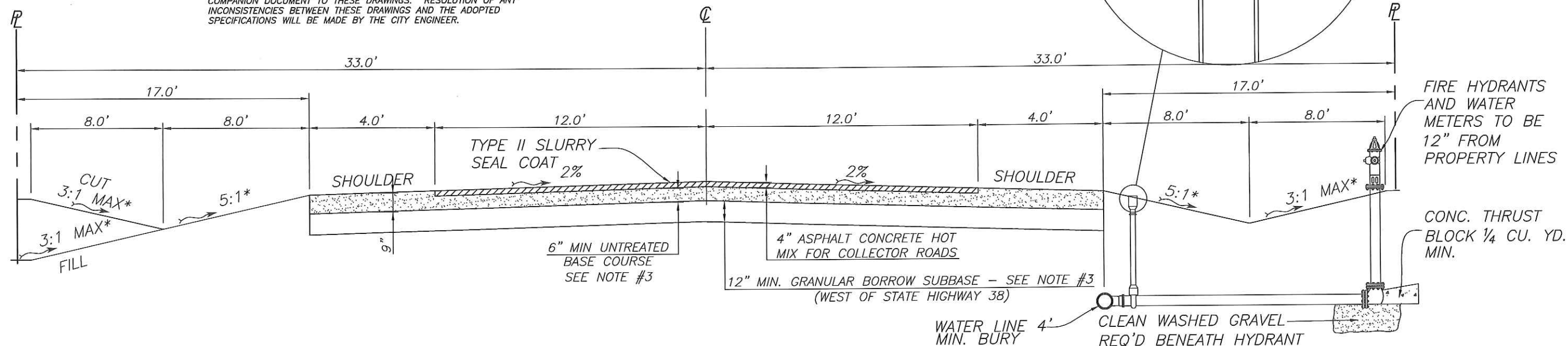

### TYPICAL 66' R.O.W. STREET SECTION (COLLECTOR ROADS)

- NOTES:
- 1 - THIS DRAWING IS NOT TO VERTICAL SCALE. VERTICAL FEATURES ARE EXAGGERATED FOR DRAWING CLARITY.
  - 2 - ALL WATER VALVES ARE TO BE FINISHED WITH CONCRETE COLLARS AT THE SURFACE.
  - 3 - THE GRANULAR BORROW, CRUSHED GRAVEL, AND ASPHALT THICKNESSES SHOWN ARE CONSIDERED AS CITY MINIMUM STANDARDS FOR ALL AREAS WEST OF STATE HIGHWAY 38. DUE TO CHARACTERISTICS OF GRANULAR NATIVE SOILS MANY AREAS EAST OF STATE HIGHWAY 38 MAY BE REDUCED TO 0-INCHES OF GRANULAR BORROW, 8-INCHES OF CRUSHED GRAVEL, AND 4-INCHES OF ASPHALT CONCRETE HOT MIX. AREAS EAST OF STATE HIGHWAY 38 WILL BE CONSIDERED ON A CASE BY CASE BASIS. GEOTECHNICAL SOILS STUDIES ARE REQUIRED FOR ALL NEW PROPOSED ROADS TO VERIFY THE APPROPRIATE THICKNESSES SHOWN AND DESCRIBED HEREON ARE ADEQUATE FOR THE PROPOSED SERVICE THE NEW ROADS WILL PROVIDE. IF THE NEW ROADS ARE PROPOSED AS PART OF OR WITHIN A NEW DEVELOPMENT OR SUBDIVISION, THE DEVELOPER OR SUBDIVIDER IS RESPONSIBLE FOR THE COST OF FURNISHING THE GEOTECHNICAL SOIL REPORT TO HONEYVILLE CITY FOR REVIEW BY THE CITY ENGINEER.
  - 4 - USE GRADE 1 1/2 FOR UNTREATED BASE COURSE.
  - 5 - USE GRANULAR BORROW PER SECTION 02055 OF APWA STANDARD SPECIFICATIONS FOR SUB BASE.
  - 6 - USE GRADE DM - 3/4 FOR ASPHALT CONCRETE HOT MIX.

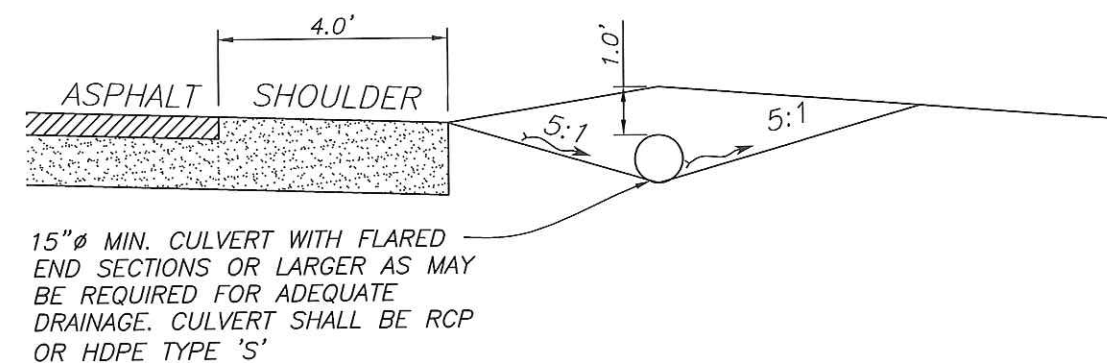

### TYPICAL DRIVEWAY DETAIL

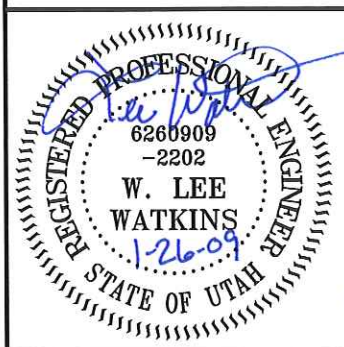

APPROVED  
  
 CITY CONSULTING ENGINEER DATE 1-26-09  
 HONEYVILLE CITY MAYOR DATE

HANSEN & ASSOCIATES, INC.  
 Consulting Engineers and Land Surveyors  
 538 North Main Brigham City, Utah 84302  
 Brigham City Ogden Logan  
 723-3491 399-4905 752-8272

REVISION DATE:  
 DATE: 1/23/09  
 SCALE: NONE

HONEYVILLE CITY  
 PUBLIC WORKS CONSTRUCTION STANDARDS  
**STREET IMPROVEMENT DETAILS**  
**66' RURAL COLLECTOR ROAD CLASSIFICATION**

SHEET:  
**2**  
 OF 13 SHEETS



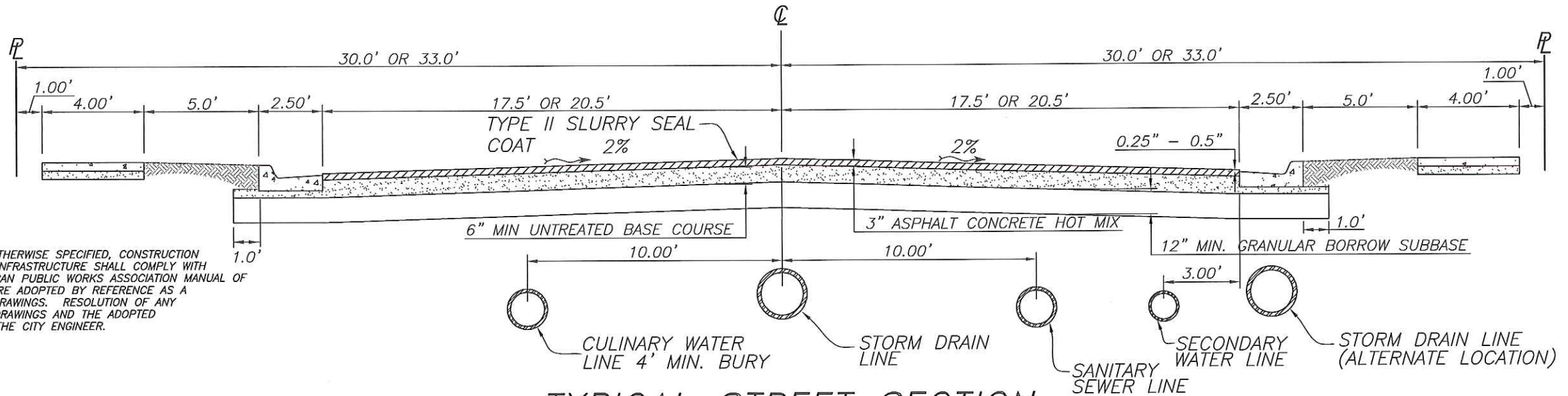

CONSTRUCTION REQUIREMENTS:  
 WHERE APPLICABLE, AND UNLESS OTHERWISE SPECIFIED, CONSTRUCTION OF PUBLIC WORKS FACILITIES AND INFRASTRUCTURE SHALL COMPLY WITH THE LATEST EDITION OF THE AMERICAN PUBLIC WORKS ASSOCIATION MANUAL OF STANDARD SPECIFICATIONS WHICH ARE ADOPTED BY REFERENCE AS A COMPANION DOCUMENT TO THESE DRAWINGS. RESOLUTION OF ANY INCONSISTENCIES BETWEEN THESE DRAWINGS AND THE ADOPTED SPECIFICATIONS WILL BE MADE BY THE CITY ENGINEER.

NOTES:

- 1 - THIS DRAWING IS NOT TO VERTICAL SCALE. VERTICAL FEATURES ARE EXAGGERATED FOR DRAWING CLARITY.
- 2 - ALL WATER VALVES, MANHOLES, AND STORM DRAIN JUNCTION BOXES ARE TO BE FINISHED WITH CONCRETE COLLARS AT THE SURFACE.
- 3 - THE GRANULAR BORROW, CRUSHED GRAVEL, AND ASPHALT THICKNESSES SHOWN ARE CONSIDERED AS CITY MINIMUM STANDARDS FOR ALL AREAS WEST OF STATE HIGHWAY 38. DUE TO CHARACTERISTICS OF GRANULAR NATIVE SOILS MANY AREAS EAST OF STATE HIGHWAY 38 MAY BE REDUCED TO 0-INCHES OF GRANULAR BORROW, 8-INCHES OF CRUSHED GRAVEL, AND 3-INCHES OF ASPHALT CONCRETE HOT MIX. AREAS EAST OF STATE HIGHWAY 38 WILL BE CONSIDERED ON A CASE BY CASE BASIS. GEOTECHNICAL SOILS STUDIES ARE REQUIRED FOR ALL NEW PROPOSED ROADS TO VERIFY THE APPROPRIATE THICKNESSES SHOWN AND DESCRIBED HEREON ARE ADEQUATE FOR THE PROPOSED SERVICE THE NEW ROADS WILL PROVIDE. IF THE NEW ROADS ARE PROPOSED AS PART OF OR WITHIN A NEW DEVELOPMENT OR SUBDIVISION, THE DEVELOPER OR SUBDIVIDER IS RESPONSIBLE FOR THE COST OF FURNISHING THE GEOTECHNICAL SOIL REPORT TO HONEYVILLE CITY FOR REVIEW BY THE CITY ENGINEER.
- 4 - USE GRADE 1 1/2 FOR UNTREATED BASE COURSE.
- 5 - USE GRANULAR BORROW PER SECTION 02055 OF APWA STANDARD SPECIFICATIONS FOR SUB BASE.
- 6 - USE GRADE DM - 3/4 FOR ASPHALT CONCRETE HOT MIX.
- 7 - MINIMUM CURB & GUTTER SLOPE TO BE 0.4%.

**TYPICAL STREET SECTION**

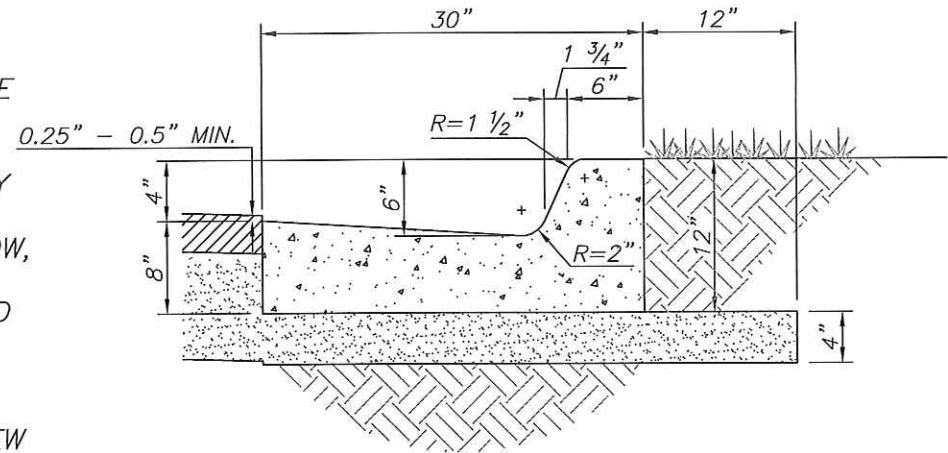

**CURB & GUTTER SECTION**

NOT TO SCALE

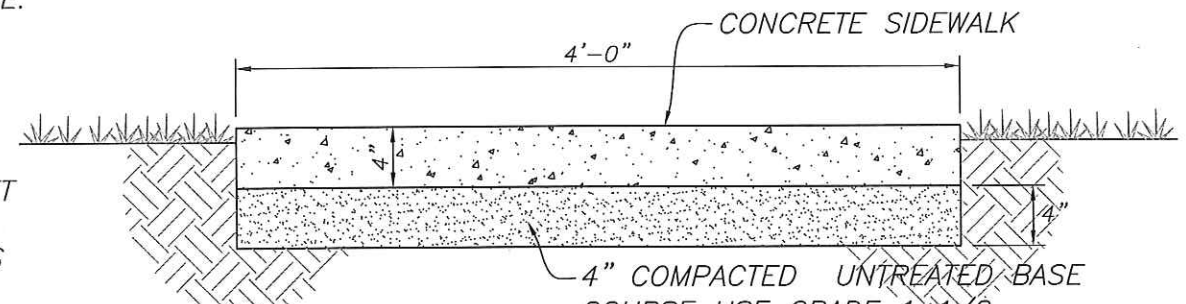

**SIDEWALK SECTION**

NOT TO SCALE

SIDEWALK NOTES:

CONTRACTION JOINT EVERY 10' FEET

CONCRETE SHALL BE 6\"/>

EXPANSION MATERIAL REQ'D AT CONSTRUCTION JOINTS

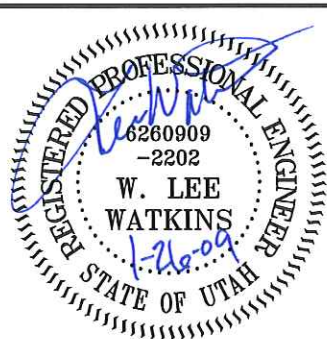

*W. Lee Watkins*  
 W. LEE WATKINS  
 CITY CONSULTING ENGINEER  
 DATE 1-26-09

APPROVED  
 \_\_\_\_\_  
 HONEYVILLE CITY MAYOR  
 DATE \_\_\_\_\_

**HANSEN & ASSOCIATES, INC.**  
 Consulting Engineers and Land Surveyors  
 538 North Main Brigham City, Utah 84302  
 Brigham City Ogden Logan  
 723-3491 399-4905 752-8272

REVISION DATE:  
 DATE: 1/23/09  
 SCALE: NONE

HONEYVILLE CITY  
 PUBLIC WORKS CONSTRUCTION STANDARDS  
**STREET IMPROVEMENT DETAILS**  
**URBAN CLASSIFICATION**  
 (1/2 ACRE OR SMALLER LOT SIZE)

SHEET:  
**3**  
 OF 13 SHEETS



N:\Details\Cty Standards\08-30-12 Honeyville\Honeyville Town Standards.dwg, Sheet4, 1/26/2009 11:10:12 AM, 1:2

ALL SIGNS SHALL CONFORM TO THE REQUIREMENTS OF THE LATEST REVISION OF THE "MANUAL ON UNIFORM TRAFFIC CONTROL DEVICES"

TRAFFIC SIGN NOTES:

1. BACKGROUND SHALL BE GREEN, HIGH INTENSITY REFLECTIVE SHEETING (FS L-S-300) IN ACCORDANCE WITH SECTION 02842 PART 2.1.A OF THE MANUAL OF STANDARD SPECIFICATIONS PUBLISHED BY THE UTAH CHAPTER OF THE AMERICAN PUBLIC WORKS ASSOCIATION.
2. LEGEND SHALL BE WHITE LETTER TYPE 3 (PERMANENTLY ATTACHED CUTOUT LETTERS, SYMBOLS, AND BORDERS OR SCREEN PROCESSED LETTERS, SYMBOLS, AND BORDERS).
3. SHEET ALUMINUM SIGN BLANKS: BLANK SHALL BE 0.1 INCH THICK ASTM B 209 ALLOY 6061-T6 OF THE HEIGHT INDICATED WITH LENGTH REQUIRED TO SPELL THE STREET NAME (18",24",30",36",42",48").
4. SIGN ON PRIVATE ROADS SHALL MEET ALL SPECIFICATIONS FOR STANDARD SIGNS, EXCEPT BACKGROUND SHALL BE BLUE AND LEGEND WHITE.
5. ALL STREETS WITH NAMES MUST ALSO SHOW COORDINATE NUMBER DESIGNATIONS AS SHOWN.
6. COMMUNITY ADDRESS COORDINATOR MUST BE CONTACTED PRIOR TO MAKING SIGNS TO VERIFY PROPER NAMES AND COORDINATES.
7. IF STREET HAS CONCRETE CURB, SIGN POST TO BE PLACED AT THE POINT OF CURVE (PC) OF THE INTERSECTION APPROACH CURB. OTHERWISE SIGN SHALL BE PLACED AT PC OF ASPHALT RADIUS APPROACH.
8. NO OTHER SIGNS MAY BE ATTACHED ON THE POST OF A STOP SIGN.

CONSTRUCTION REQUIREMENTS: WHERE APPLICABLE, AND UNLESS OTHERWISE SPECIFIED, CONSTRUCTION OF PUBLIC WORKS FACILITIES AND INFRASTRUCTURE SHALL COMPLY WITH THE LATEST EDITION OF THE AMERICAN PUBLIC WORKS ASSOCIATION MANUAL OF STANDARD SPECIFICATIONS WHICH ARE ADOPTED BY REFERENCE AS A COMPANION DOCUMENT TO THESE DRAWINGS. RESOLUTION OF ANY INCONSISTENCIES BETWEEN THESE DRAWINGS AND THE ADOPTED SPECIFICATIONS WILL BE MADE BY THE CITY ENGINEER.

LOCATION OF COORDINATE TEXT IF STREET HAS A NAME  
 WHITE LEGEND  
 GREEN

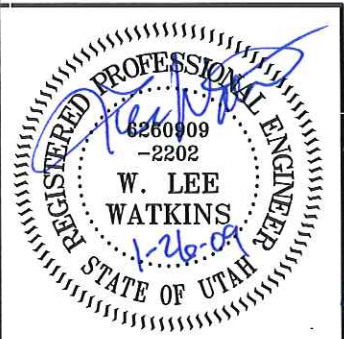
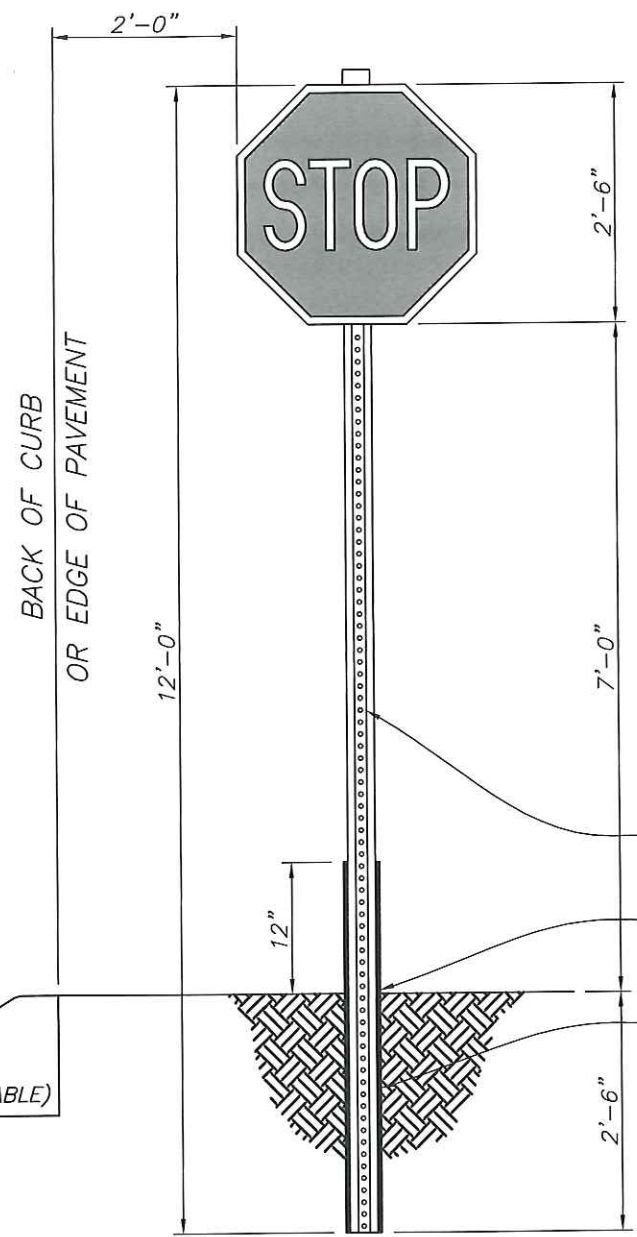
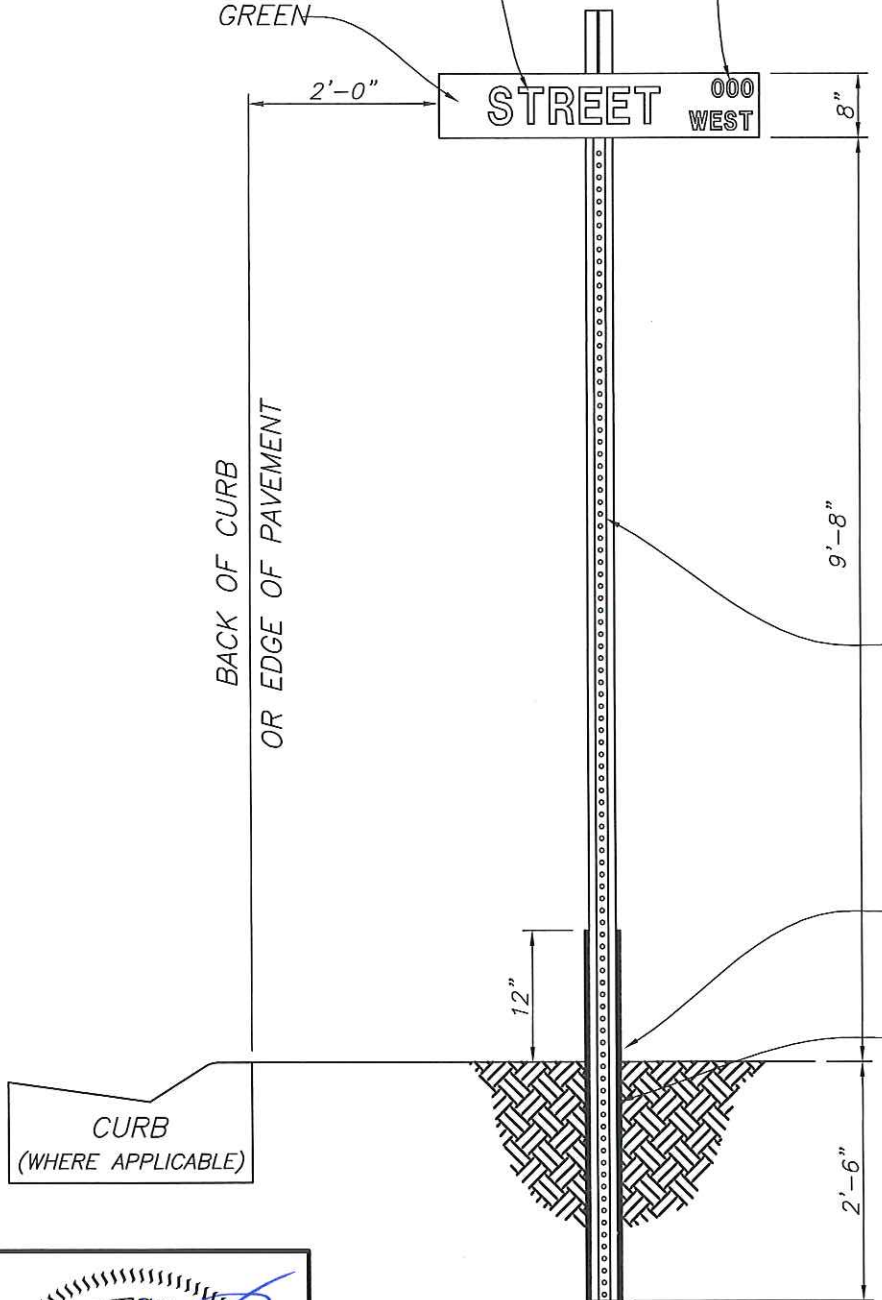

*W. Lee Watkins*  
 CITY CONSULTING ENGINEER DATE 1-26-09

APPROVED  
 \_\_\_\_\_  
 HONEYVILLE CITY MAYOR DATE

**HANSEN & ASSOCIATES, INC.**  
 Consulting Engineers and Land Surveyors  
 538 North Main Brigham City, Utah 84302  
 Brigham City Ogden Logan  
 723-3491 399-4905 752-8272

REVISION DATE:  
 DATE: 1/23/09  
 SCALE: NONE

HONEYVILLE CITY  
 PUBLIC WORKS CONSTRUCTION STANDARDS  
**STREET ADDRESS AND STOP SIGN  
 & POST DETAIL**

SHEET:  
**4**  
 OF 13 SHEETS



N:\Details\City Standards\08-30-12 Honeyville\Honeyville Town Standards.dwg, Sheet5, 1/26/2009 11:10:13 AM, 1:5

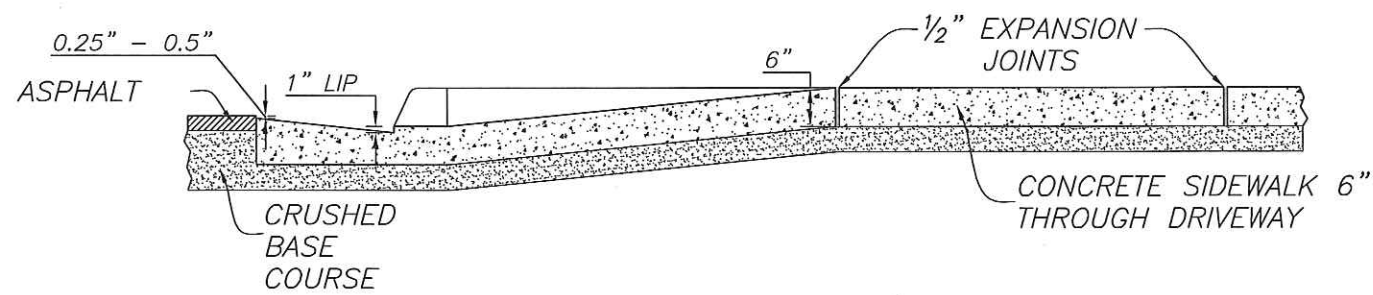

SECTION A-A

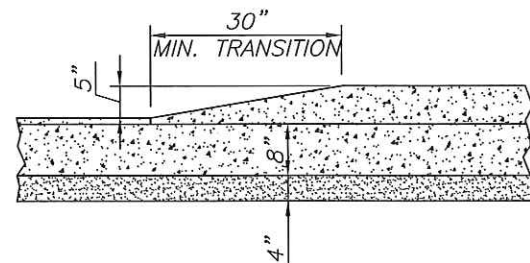

SECTION B-B

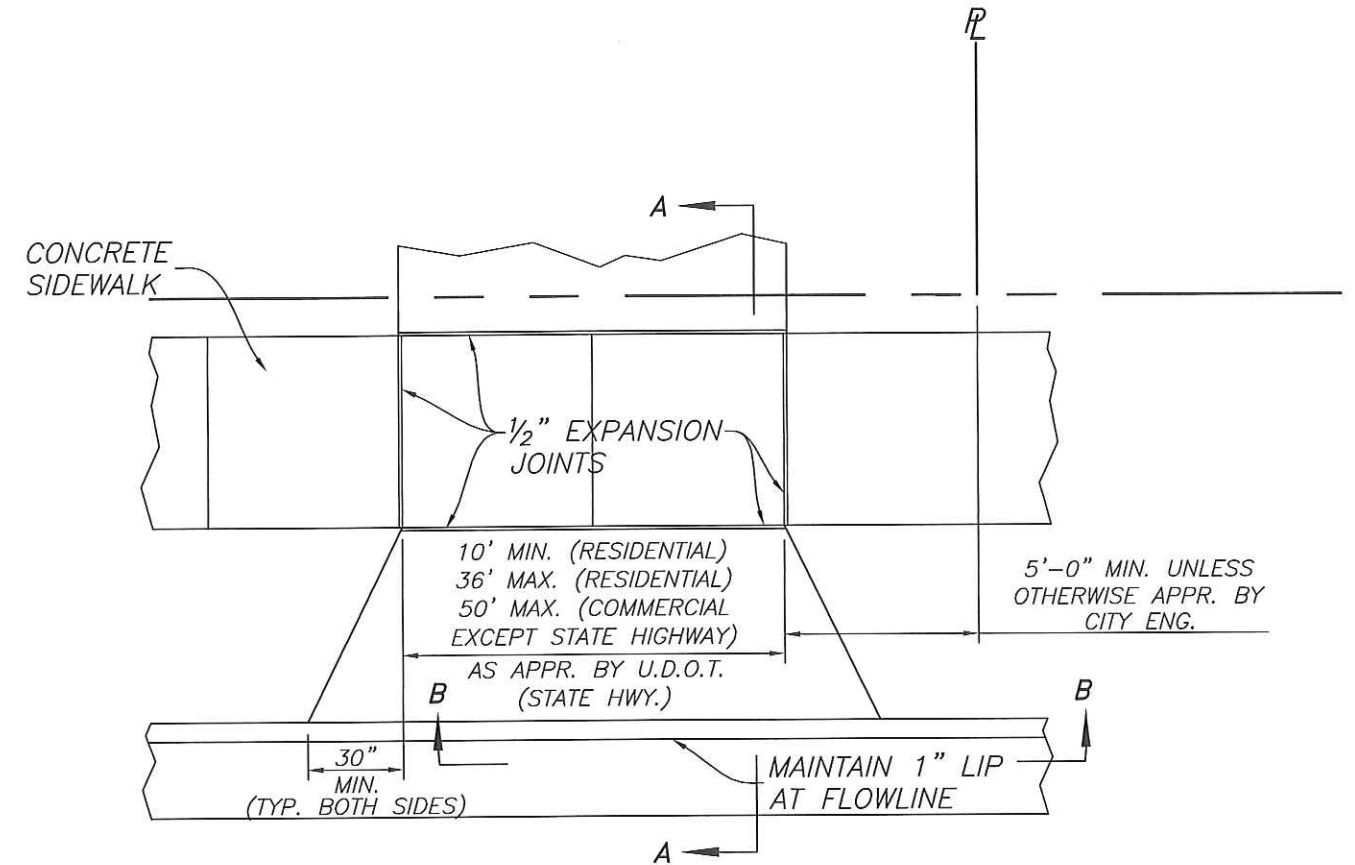

FLARED DRIVEWAY APPROACH

CONSTRUCTION REQUIREMENTS:  
 WHERE APPLICABLE, AND UNLESS OTHERWISE SPECIFIED, CONSTRUCTION OF PUBLIC WORKS FACILITIES AND INFRASTRUCTURE SHALL COMPLY WITH THE LATEST EDITION OF THE AMERICAN PUBLIC WORKS ASSOCIATION MANUAL OF STANDARD SPECIFICATIONS WHICH ARE ADOPTED BY REFERENCE AS A COMPANION DOCUMENT TO THESE DRAWINGS. RESOLUTION OF ANY INCONSISTENCIES BETWEEN THESE DRAWINGS AND THE ADOPTED SPECIFICATIONS WILL BE MADE BY THE CITY ENGINEER.

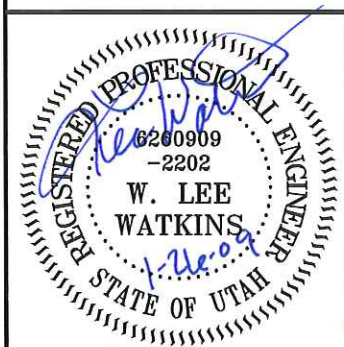

*W. Lee Watkins*  
 CITY CONSULTING ENGINEER  
 DATE 1-26-09

APPROVED  
 \_\_\_\_\_  
 HONEYVILLE CITY MAYOR  
 DATE \_\_\_\_\_

**HANSEN & ASSOCIATES, INC.**  
 Consulting Engineers and Land Surveyors  
 538 North Main Brigham City, Utah 84302  
 Brigham City Ogden Logan  
 723-3491 399-4905 752-8272

REVISION DATE:  
 DATE: 1/23/09  
 SCALE: NONE

HONEYVILLE CITY  
 PUBLIC WORKS CONSTRUCTION STANDARDS  
**TYPICAL DRIVEWAY DETAIL  
 URBAN CLASSIFICATION ONLY**

SHEET:  
**5**  
 OF 13 SHEETS



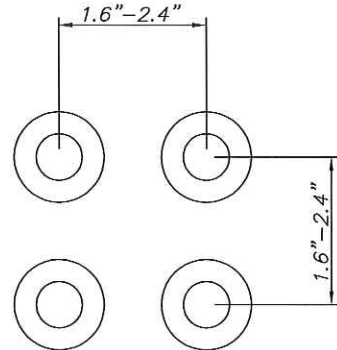
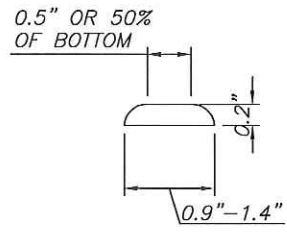

NOTES: 1. LOCATE DETECTABLE WARNINGS SO THAT THE EDGE NEAREST THE BACK OF CURB OR OTHER POTENTIAL HAZARD IS 6 INCHES FROM THE BACK OF CURB OR OTHER POTENTIAL HAZARD. PROVIDE 2-FOOT MINIMUM DEPTH.

SEE FIGURE FOR TRUNCATED DOME SIZE AND SPACING DIMENSION DETAILS.

**TRUNCATED DOME DETAIL**

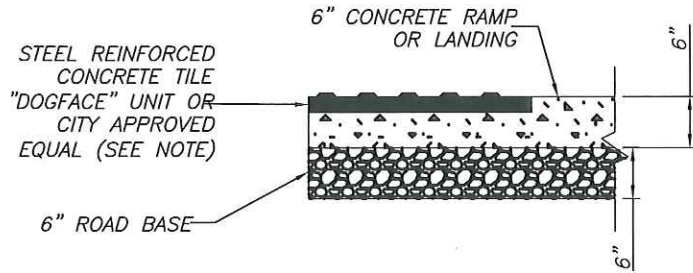

NOTES: 1. INSTALLATION SHALL BE IN ACCORDANCE WITH MANUFACTURER'S RECOMMENDATIONS.

**TILE DETAIL**

GENERAL NOTES: A. THE DETECTABLE WARNING SURFACE DOMES SHALL BE ORIENTED SUCH THAT THE ROWS ARE PARALLEL WITH THE DIRECTION OF PEDESTRIAN TRAVEL TO THE RAMP ON THE OPPOSITE SIDE OF THE STREET.

B. THE COLOR FOR THE DETECTABLE WARNING SURFACE SHALL BE HI-VISIBILITY YELLOW IN COLOR AS APPROVED BY THE COUNTY OR AUTHORIZED REPRESENTATIVE.

C. WHEN A DETECTABLE WARNING SURFACE DOME IS CUT, THE REMAINING PORTION OF THE DOME SHALL BE BEVELED TO A MAXIMUM SLOPE OF 1:2.

CONSTRUCTION REQUIREMENTS: WHERE APPLICABLE, AND UNLESS OTHERWISE SPECIFIED, CONSTRUCTION OF PUBLIC WORKS FACILITIES AND INFRASTRUCTURE SHALL COMPLY WITH THE LATEST EDITION OF THE AMERICAN PUBLIC WORKS ASSOCIATION MANUAL OF STANDARD SPECIFICATIONS WHICH ARE ADOPTED BY REFERENCE AS A COMPANION DOCUMENT TO THESE DRAWINGS. RESOLUTION OF ANY INCONSISTENCIES BETWEEN THESE DRAWINGS AND THE ADOPTED SPECIFICATIONS WILL BE MADE BY THE CITY ENGINEER.

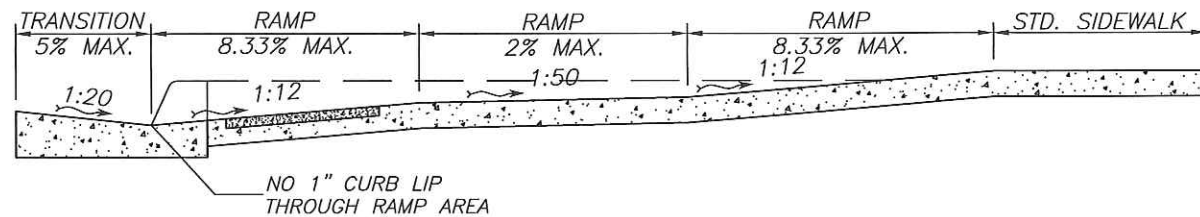

**SECTION A-A**

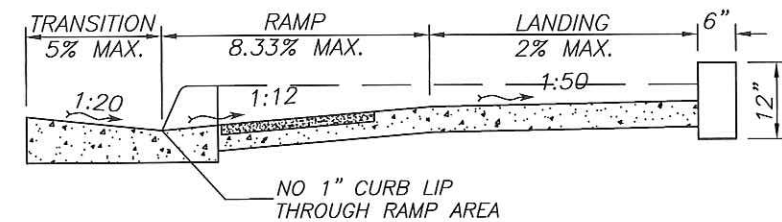
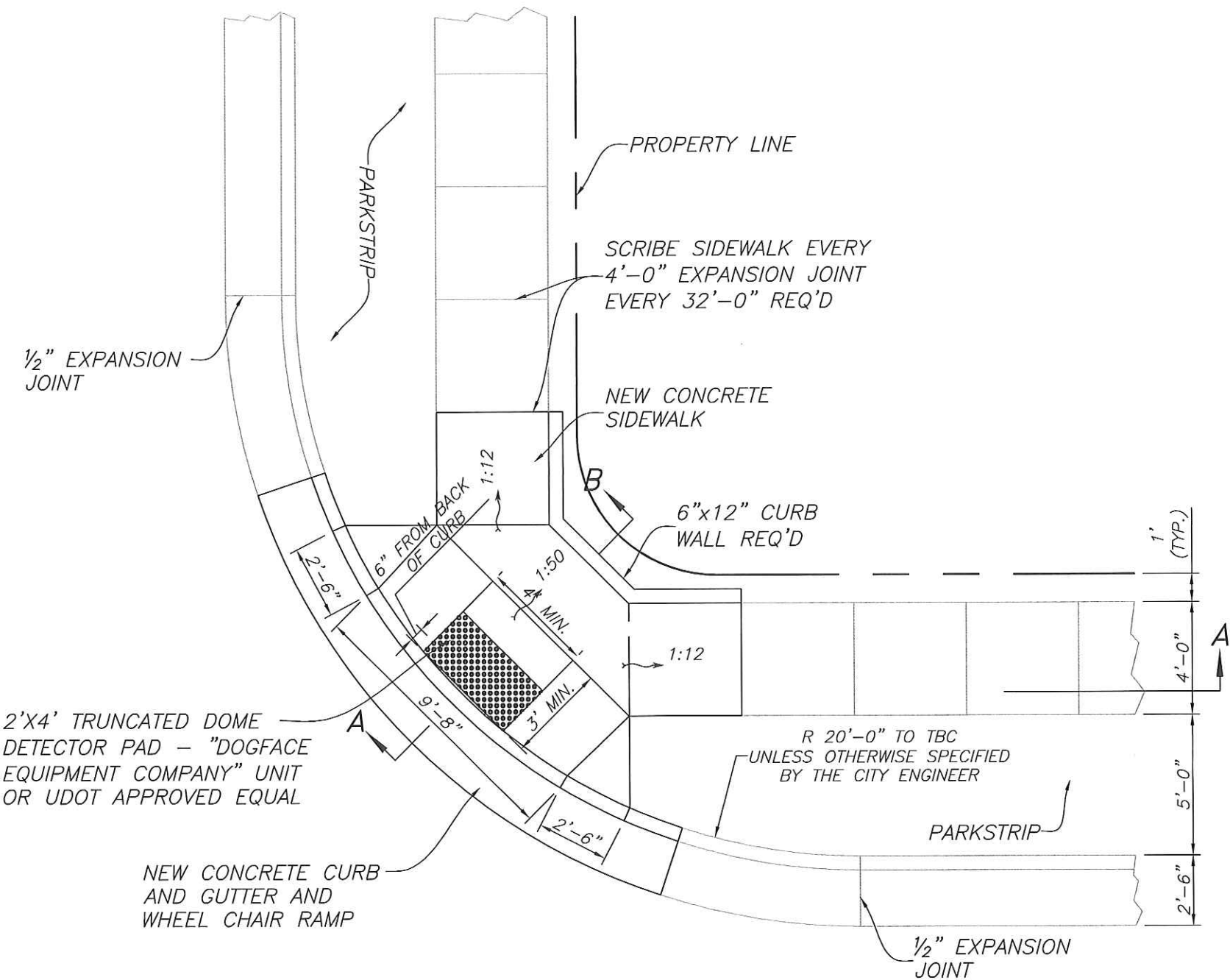

**SECTION A-B**

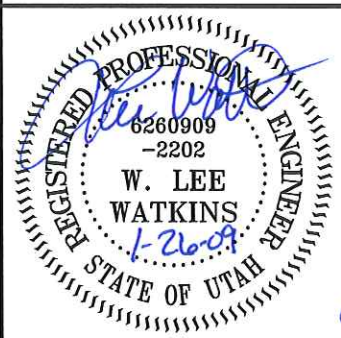

*W. Lee Watkins*  
CITY CONSULTING ENGINEER  
DATE: 1-26-09

APPROVED  
\_\_\_\_\_  
HONEYVILLE CITY MAYOR  
DATE: \_\_\_\_\_

**HANSEN & ASSOCIATES, INC.**  
Consulting Engineers and Land Surveyors  
538 North Main Brigham City, Utah 84302  
Brigham City Ogden Logan  
723-3491 399-4905 752-8272

REVISION DATE:  
DATE: 1/23/09  
SCALE: NONE

HONEYVILLE CITY  
PUBLIC WORKS CONSTRUCTION STANDARDS  
**TYPICAL HANDICAP RAMP**  
**URBAN CLASSIFICATION ONLY**

SHEET:  
**6**  
OF 13 SHEETS



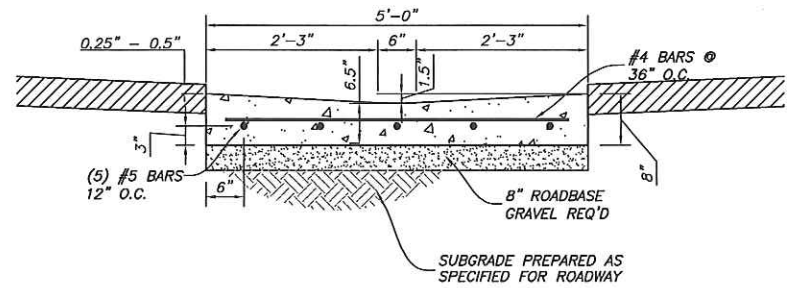

**CONCRETE WATERWAY SECTION**  
NOT TO SCALE

SIDEWALK EXPANSION JOINTS EVERY 32' & SCRIBE JOINTS EVERY 4' (TYPICAL)

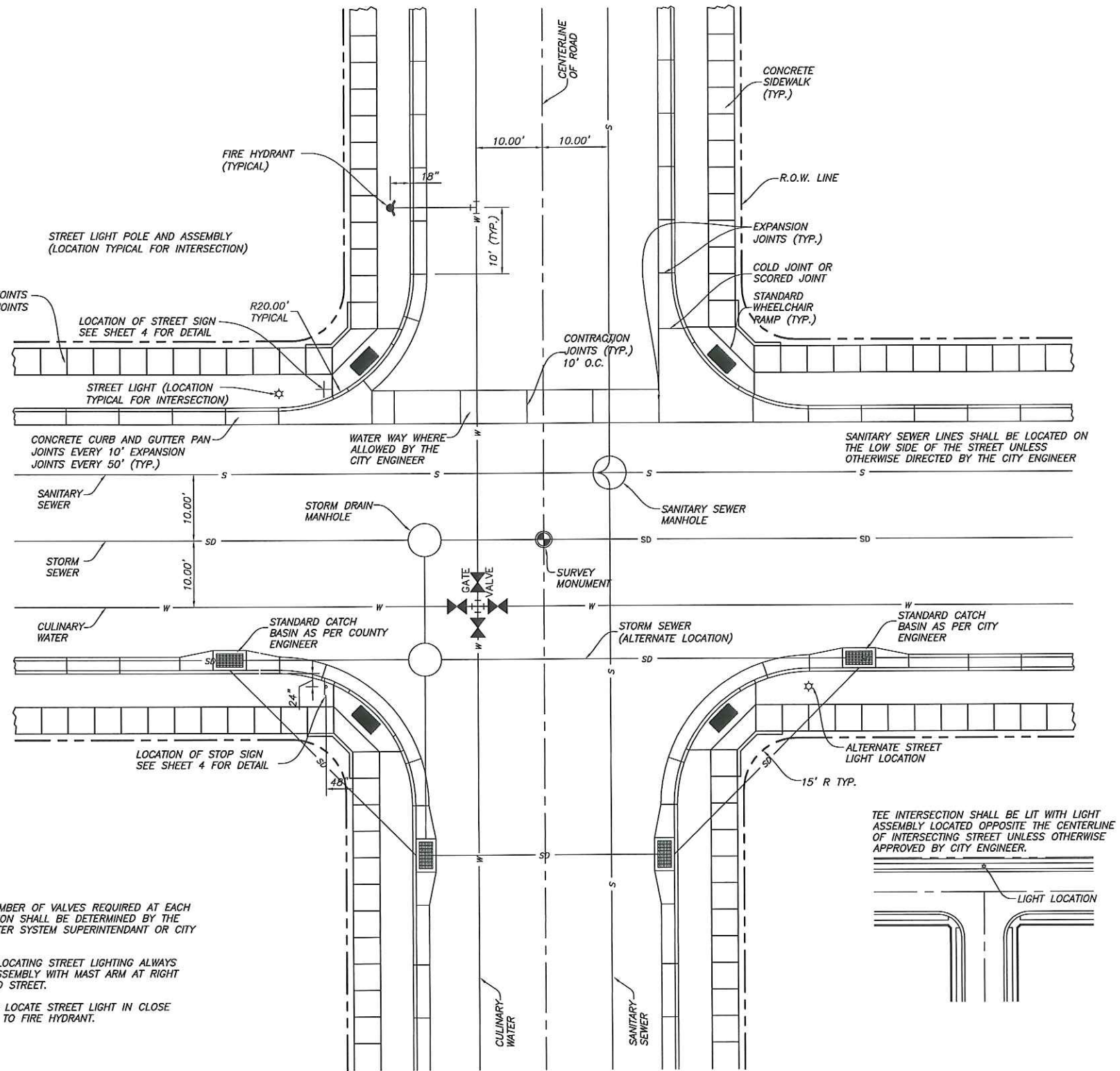

**NOTES:**

1. THE NUMBER OF VALVES REQUIRED AT EACH INTERSECTION SHALL BE DETERMINED BY THE LOCAL WATER SYSTEM SUPERINTENDANT OR CITY ENGINEER.
2. WHEN LOCATING STREET LIGHTING ALWAYS INSTALL ASSEMBLY WITH MAST ARM AT RIGHT ANGLES TO STREET.
3. ALWAYS LOCATE STREET LIGHT IN CLOSE PROXIMITY TO FIRE HYDRANT.

CONSTRUCTION REQUIREMENTS: WHERE APPLICABLE, AND UNLESS OTHERWISE SPECIFIED, CONSTRUCTION OF PUBLIC WORKS FACILITIES AND INFRASTRUCTURE SHALL COMPLY WITH THE LATEST EDITION OF THE AMERICAN PUBLIC WORKS ASSOCIATION MANUAL OF STANDARD SPECIFICATIONS WHICH ARE ADOPTED BY REFERENCE AS A COMPANION DOCUMENT TO THESE DRAWINGS. RESOLUTION OF ANY INCONSISTENCIES BETWEEN THESE DRAWINGS AND THE ADOPTED SPECIFICATIONS WILL BE MADE BY THE CITY ENGINEER.

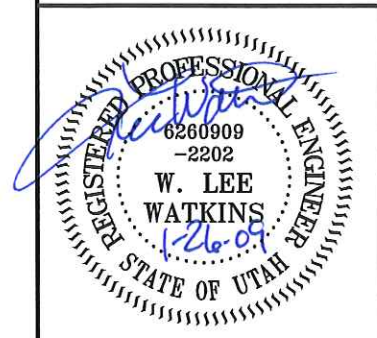

APPROVED	
 CITY CONSULTING ENGINEER	DATE 1-26-09
HONEYVILLE CITY MAYOR	DATE

<b>HANSEN &amp; ASSOCIATES, INC.</b> Consulting Engineers and Land Surveyors		
538 North Main	Brigham City, Utah	84302
Brigham City	Ogden	Logan
723-3491	399-4905	752-8272
REVISION DATE:		
DATE: 1/23/09		
SCALE: NONE		

HONEYVILLE CITY PUBLIC WORKS CONSTRUCTION STANDARDS <b>TYPICAL STREET INTERSECTION</b> <b>URBAN CLASSIFICATION ONLY</b>
--

SHEET: <b>7</b> OF 13 SHEETS
------------------------------------



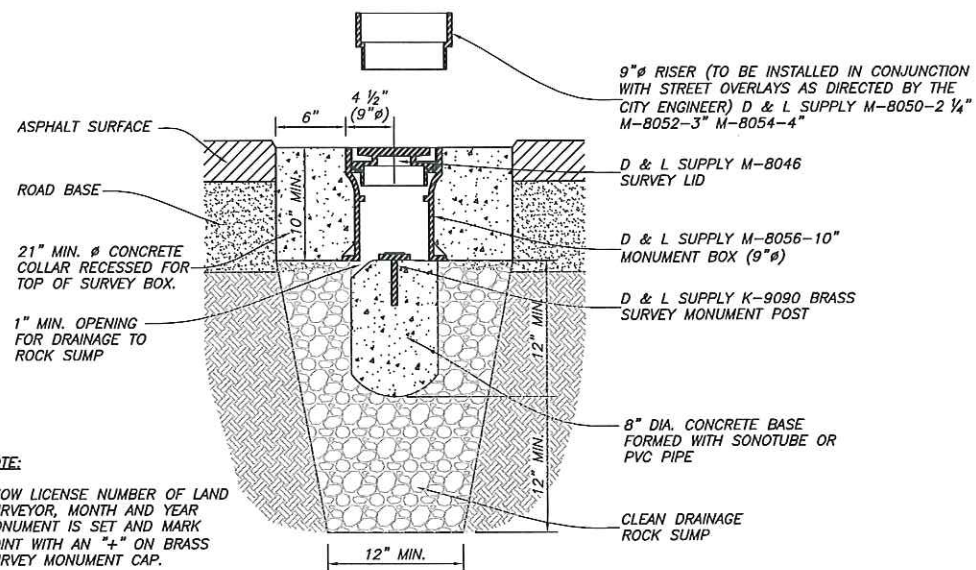

**SURVEY MONUMENT DETAIL**  
NOT TO SCALE

**NOTE:**  
SHOW LICENSE NUMBER OF LAND SURVEYOR, MONTH AND YEAR MONUMENT IS SET AND MARK POINT WITH AN "+\"/>

**CONSTRUCTION REQUIREMENTS:**  
WHERE APPLICABLE, AND UNLESS OTHERWISE SPECIFIED, CONSTRUCTION OF PUBLIC WORKS FACILITIES AND INFRASTRUCTURE SHALL COMPLY WITH THE LATEST EDITION OF THE AMERICAN PUBLIC WORKS ASSOCIATION MANUAL OF STANDARD SPECIFICATIONS WHICH ARE ADOPTED BY REFERENCE AS A COMPANION DOCUMENT TO THESE DRAWINGS. RESOLUTION OF ANY INCONSISTENCIES BETWEEN THESE DRAWINGS AND THE ADOPTED SPECIFICATIONS WILL BE MADE BY THE CITY ENGINEER.

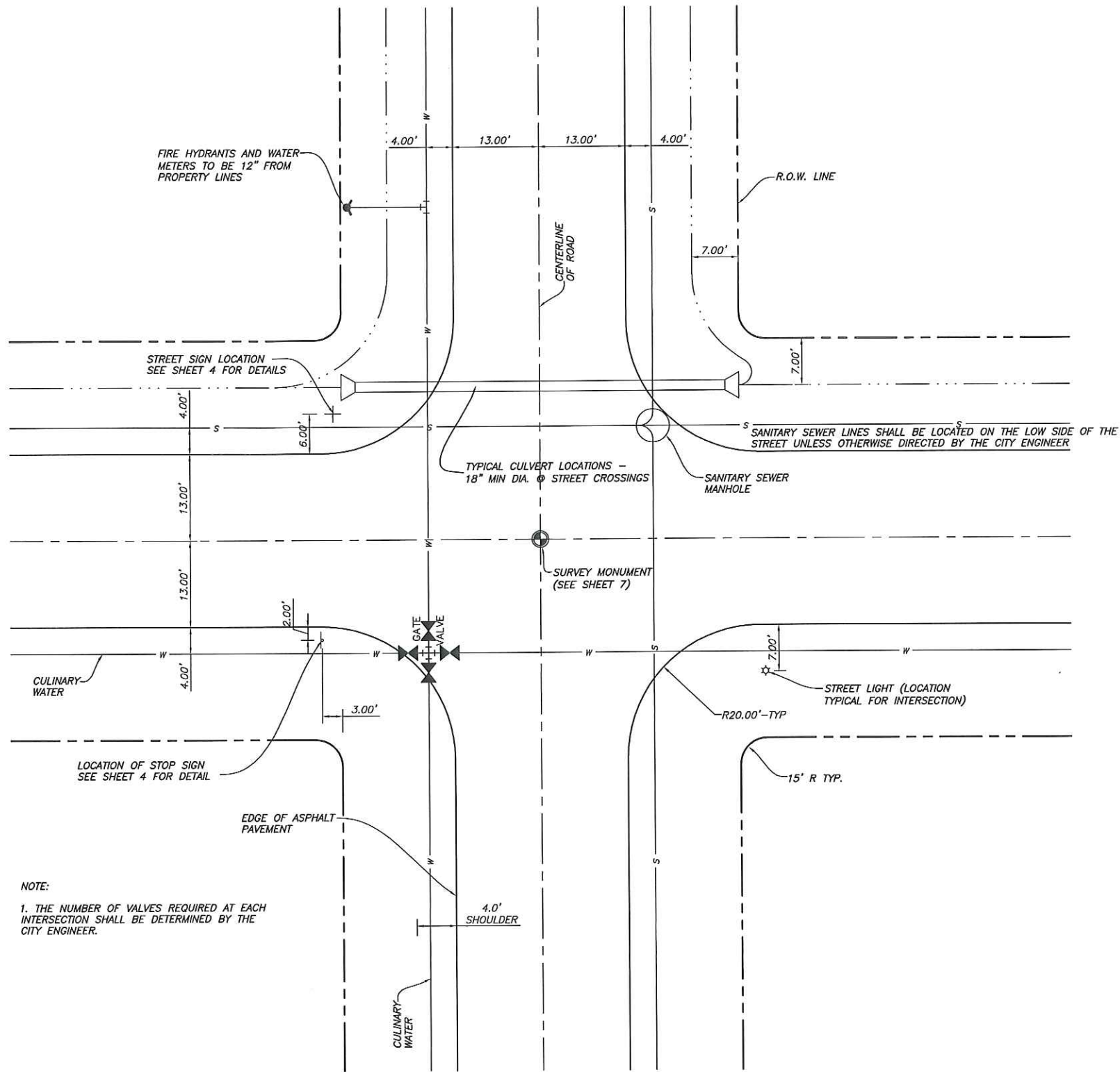

**NOTE:**  
1. THE NUMBER OF VALVES REQUIRED AT EACH INTERSECTION SHALL BE DETERMINED BY THE CITY ENGINEER.

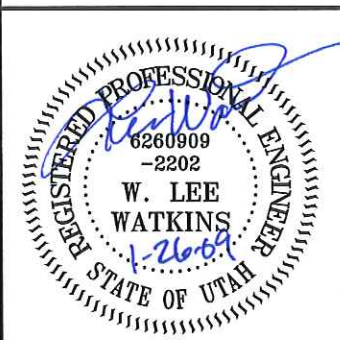

*W. Lee Watkins*  
CITY CONSULTING ENGINEER  
DATE: 1-26-09

APPROVED  
\_\_\_\_\_  
HONEYVILLE CITY MAYOR  
DATE: \_\_\_\_\_

**HANSEN & ASSOCIATES, INC.**  
Consulting Engineers and Land Surveyors  
538 North Main Brigham City, Utah 84302  
Brigham City Ogden Logan  
723-3491 399-4905 752-8272

REVISION DATE:  
DATE: 1/23/09  
SCALE: NONE

HONEYVILLE CITY  
PUBLIC WORKS CONSTRUCTION STANDARDS  
**TYPICAL STREET INTERSECTION**  
**RURAL CLASSIFICATION**

SHEET:  
**8**  
OF 13 SHEETS



DRAINAGE DITCH (DIRECTION OF DRAINAGE TO BE APPROVED BY THE CITY ENGINEER)

DRAINAGE DITCH (DIRECTION DICTATED BY TOPOGRAPHY)

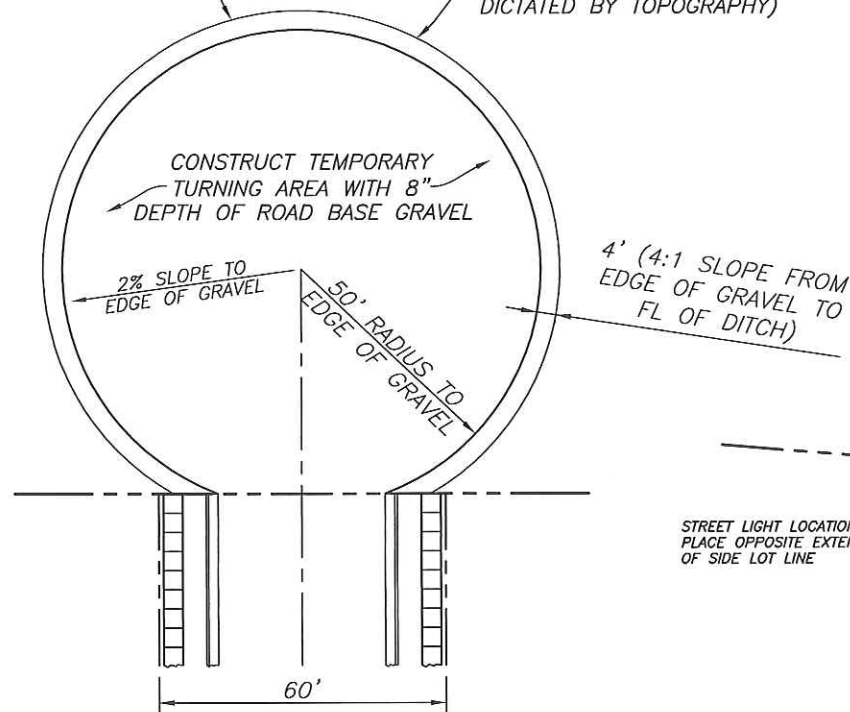

**TEMPORARY TURNAROUND**  
NOT TO SCALE

**NOTE:**

WHEN TURNAROUND CANNOT BE CONSTRUCTED OUTSIDE OF THE SUBDIVISION, IT SHALL BE LOCATED ON A PORTION OF THE SUBDIVISION LOTS (AS NEEDED) WITH THE SUBDIVIDER PLACING IN ESCROW AN AMOUNT OF MONEY SUFFICIENT TO COMPLETE THE STREET IMPROVEMENTS TO THE SUBDIVISION BOUNDARY. THESE FUNDS WILL BE USED AT SUCH TIME THE STREET IS EXTENDED.

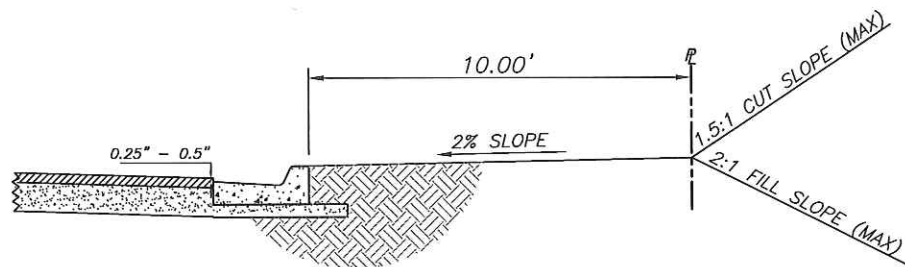

**SECTION A-A**  
NOT TO SCALE

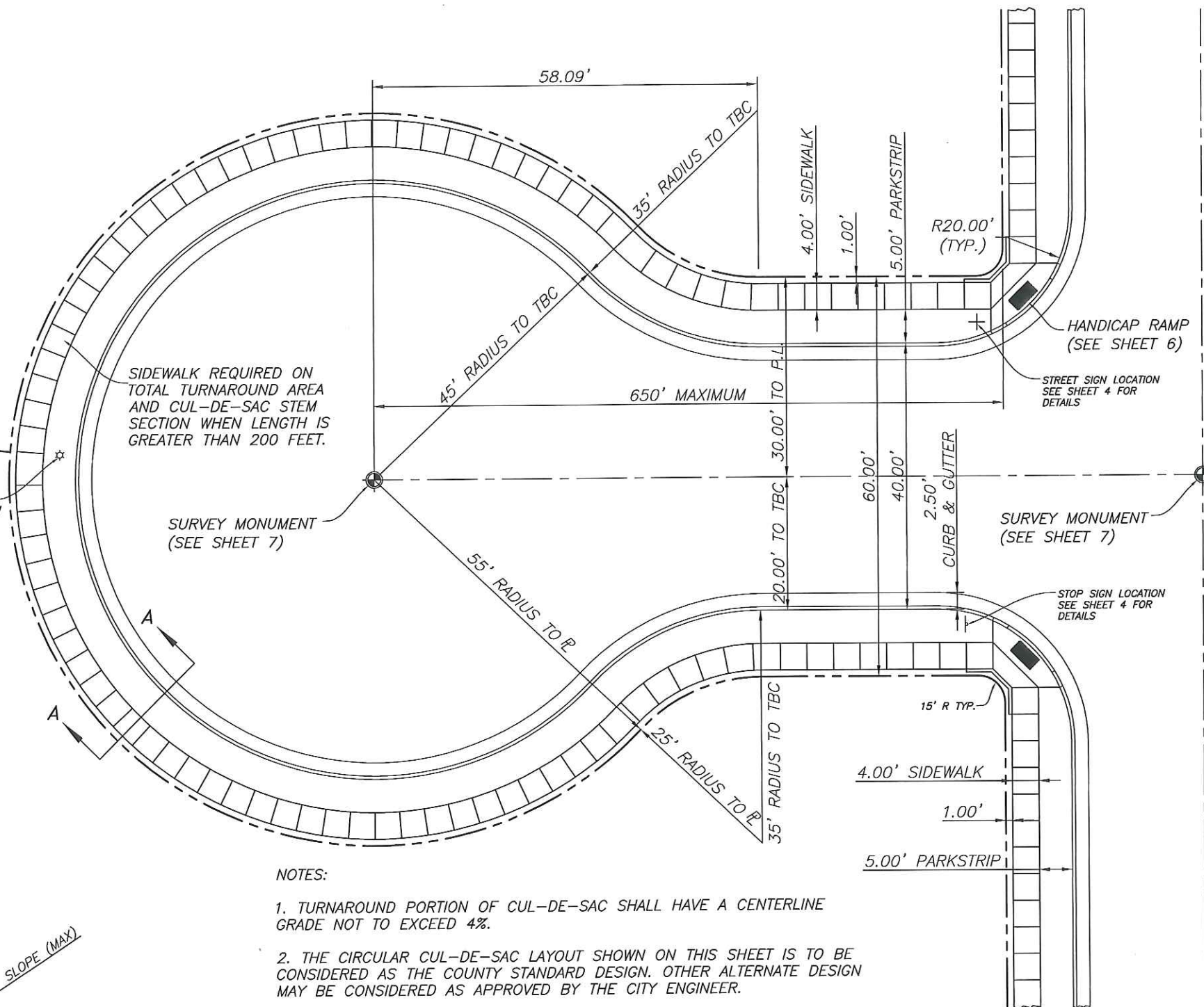

**NOTES:**

1. TURNAROUND PORTION OF CUL-DE-SAC SHALL HAVE A CENTERLINE GRADE NOT TO EXCEED 4%.
2. THE CIRCULAR CUL-DE-SAC LAYOUT SHOWN ON THIS SHEET IS TO BE CONSIDERED AS THE COUNTY STANDARD DESIGN. OTHER ALTERNATE DESIGN MAY BE CONSIDERED AS APPROVED BY THE CITY ENGINEER.

CONSTRUCTION REQUIREMENTS: WHERE APPLICABLE, AND UNLESS OTHERWISE SPECIFIED, CONSTRUCTION OF PUBLIC WORKS FACILITIES AND INFRASTRUCTURE SHALL COMPLY WITH THE LATEST EDITION OF THE AMERICAN PUBLIC WORKS ASSOCIATION MANUAL OF STANDARD SPECIFICATIONS WHICH ARE ADOPTED BY REFERENCE AS A COMPANION DOCUMENT TO THESE DRAWINGS. RESOLUTION OF ANY INCONSISTENCIES BETWEEN THESE DRAWINGS AND THE ADOPTED SPECIFICATIONS WILL BE MADE BY THE CITY ENGINEER.

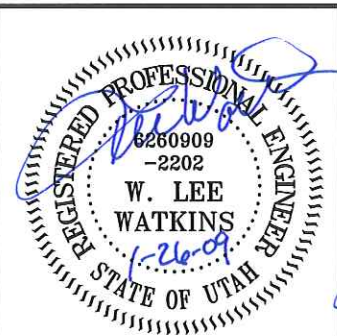

*W. Lee Watkins*  
CITY CONSULTING ENGINEER  
DATE: 1-26-09

APPROVED  
  
HONEYVILLE CITY MAYOR  
DATE

**HANSEN & ASSOCIATES, INC.**  
Consulting Engineers and Land Surveyors  
538 North Main Brigham City, Utah 84302  
Brigham City Ogden Logan  
723-3491 399-4905 752-8272

REVISION DATE:  
DATE: 1/23/09  
SCALE: NONE

HONEYVILLE CITY  
PUBLIC WORKS CONSTRUCTION STANDARDS  
**TYPICAL CUL-DE-SAC DETAIL**  
**URBAN CLASSIFICATION ONLY**

SHEET:  
**9**  
OF 13 SHEETS



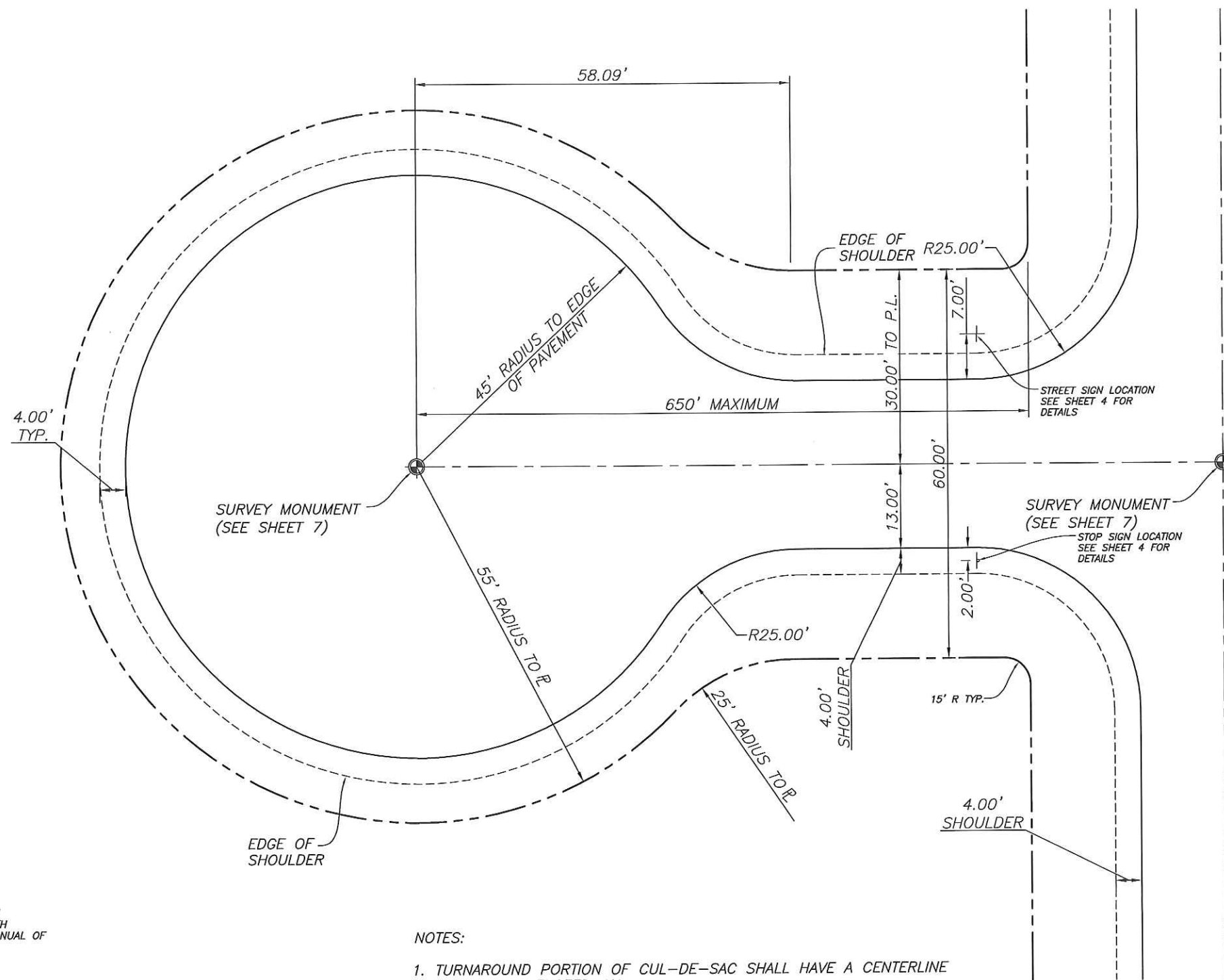

CONSTRUCTION REQUIREMENTS:  
WHERE APPLICABLE, AND UNLESS OTHERWISE SPECIFIED, CONSTRUCTION OF PUBLIC WORKS FACILITIES AND INFRASTRUCTURE SHALL COMPLY WITH THE LATEST EDITION OF THE AMERICAN PUBLIC WORKS ASSOCIATION MANUAL OF STANDARD SPECIFICATIONS WHICH ARE ADOPTED BY REFERENCE AS A COMPANION DOCUMENT TO THESE DRAWINGS. RESOLUTION OF ANY INCONSISTENCIES BETWEEN THESE DRAWINGS AND THE ADOPTED SPECIFICATIONS WILL BE MADE BY THE CITY ENGINEER.

NOTES:

1. TURNAROUND PORTION OF CUL-DE-SAC SHALL HAVE A CENTERLINE GRADE NOT TO EXCEED 4%.
2. THE CIRCULAR CUL-DE-SAC LAYOUT SHOWN ON THIS SHEET IS TO BE CONSIDERED AS THE COUNTY STANDARD DESIGN. OTHER ALTERNATE DESIGN MAY BE CONSIDERED AS APPROVED BY THE CITY ENGINEER.

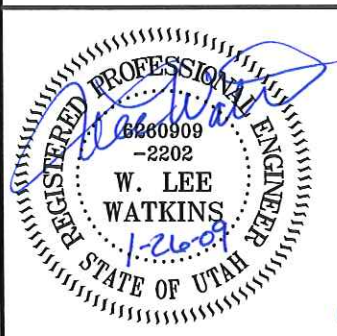

*W. Lee Watkins*  
W. LEE WATKINS  
1-26-09  
CITY CONSULTING ENGINEER DATE

APPROVED  
\_\_\_\_\_  
HONEYVILLE CITY MAYOR DATE

**HANSEN & ASSOCIATES, INC.**  
Consulting Engineers and Land Surveyors  
538 North Main Brigham City, Utah 84302  
Brigham City Ogden Logan  
723-3491 399-4905 752-8272

REVISION DATE:  
DATE: 1/23/09  
SCALE: NONE

HONEYVILLE CITY  
PUBLIC WORKS CONSTRUCTION STANDARDS  
**TYPICAL CUL-DE-SAC DETAIL**  
**RURAL CLASSIFICATION**

SHEET:  
**10**  
OF 13 SHEETS



N:\Details\City Standards\08-30-12 Honeyville\Honeyville Town Standards.dwg, Sheet11, 1/26/2009 11:10:09 AM, 1:10

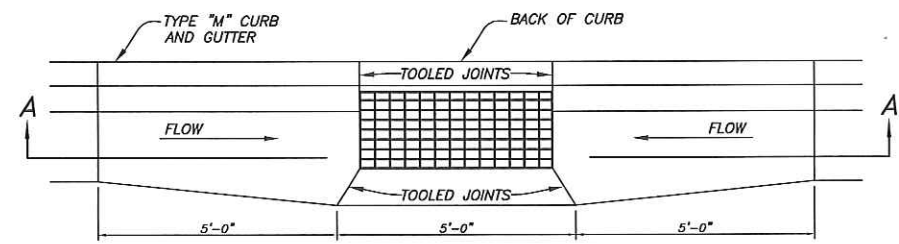

PLAN VIEW

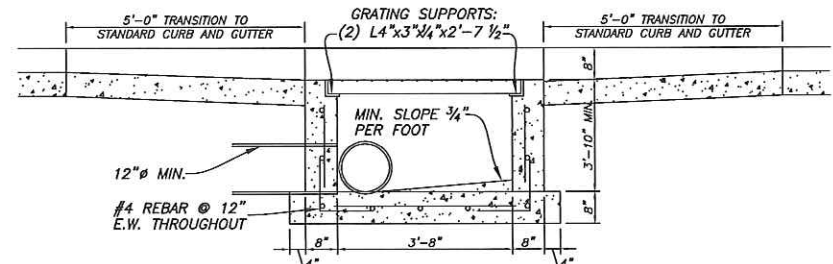

SECTION A-A

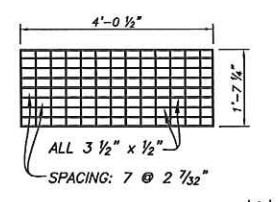

GRATE DETAIL

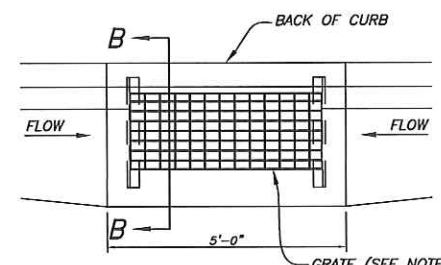

GRATE PLAN

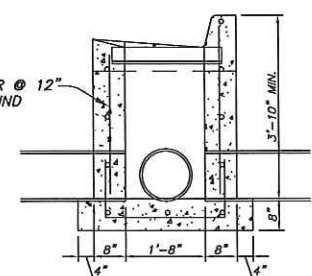

SECTION B-B

CONTRACTOR MAY SUBSTITUTE AMCOR PRECAST CB110 CATCH BASIN OR APPROVED EQUAL

TYPICAL CURB INLET BOX

- NOTES:
1. ALL GRATES SHALL BE U.D.O.T. STANDARD V-988 OR D&L SUPPLY, N-9221, AS SHOWN IN DETAIL AND GALVANIZED IN ACCORDANCE WITH U.D.O.T. STANDARDS.
  2. BICYCLE SAFE GRATE REQ'D.
  3. OPTIONAL- INLET BOX MAY BE CONSTRUCTED WITH D&L SUPPLY 1-3517 FRAME, GRATE & CURB BOX. SEE PLAN NO. 315 OF APWA MANUAL OF STANDARD PLANS.

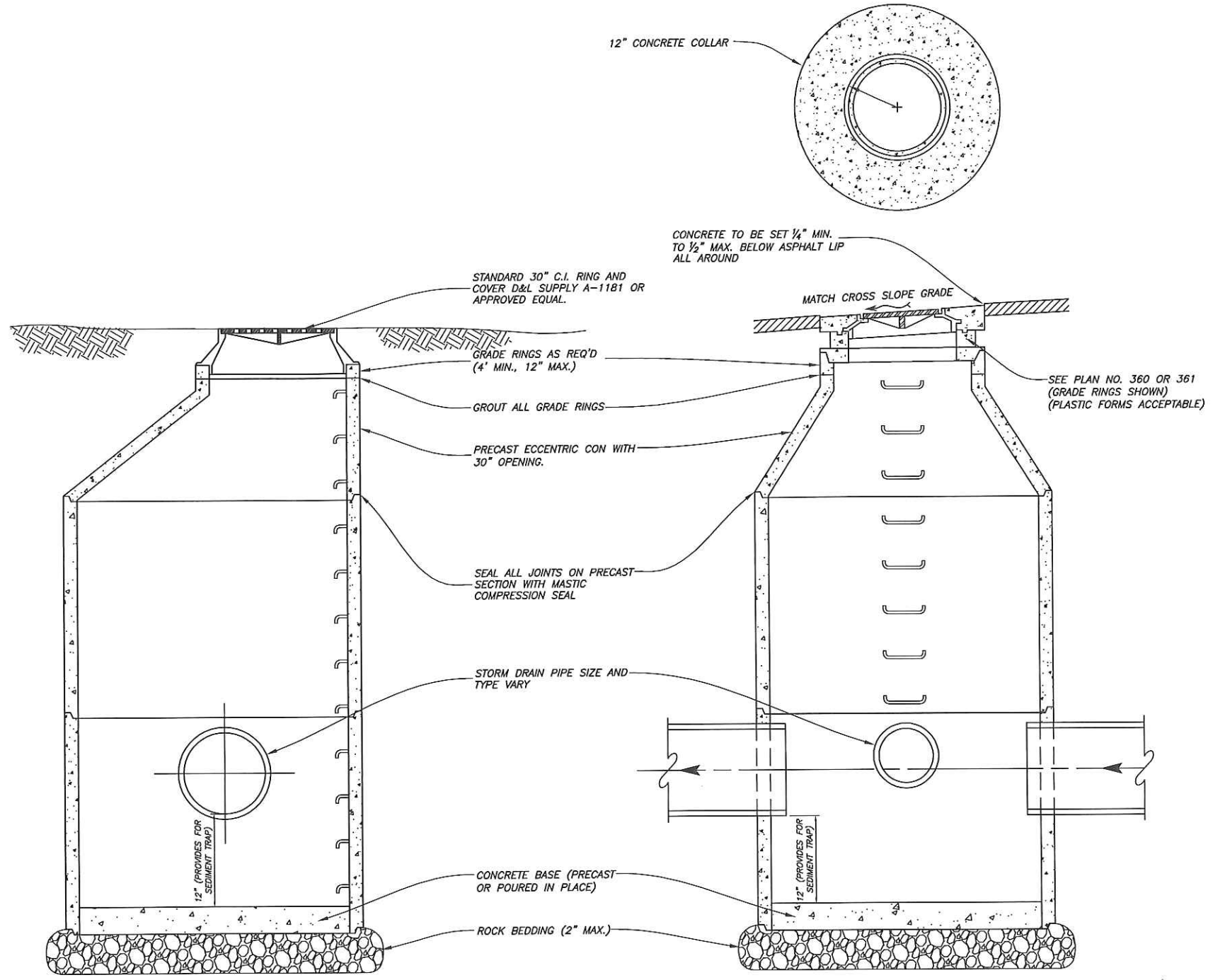

TYPICAL LINE MANHOLE

NOT TO SCALE

TYPICAL JUNCTION MANHOLE

NOT TO SCALE

- NOTE:
1. 4' MANHOLE REQ'D WHERE LINE SIZE IS 15" OR SMALLER, 5' MANHOLE REQ'D WHERE LINE SIZE IS LARGER THAN 15" AND/OR THE MANHOLE IS AT A JUNCTION.

- COVER COLLAR FOR STORM DRAINS
1. CONCRETE: CLASS 4000 PER APWA SECTION 03304. PLACE PER APWA SECTION 03310. CURE PER APWA SECTION 03390.
  2. JOINTS: PROVIDE A NEAT STRAIGHT JOINT BETWEEN EXISTING AND NEW ASPHALT CONCRETE SURFACES. PROVIDE CONCENTRIC CIRCLE OR STRAIGHT EDGE CUT. CLEAN EDGES OF ALL DIRT, OIL, AND LOOSE DEBRIS.

CONSTRUCTION REQUIREMENTS: WHERE APPLICABLE, AND UNLESS OTHERWISE SPECIFIED, CONSTRUCTION OF PUBLIC WORKS FACILITIES AND INFRASTRUCTURE SHALL COMPLY WITH THE LATEST EDITION OF THE AMERICAN PUBLIC WORKS ASSOCIATION MANUAL OF STANDARD SPECIFICATIONS WHICH ARE ADOPTED BY REFERENCE AS A COMPANION DOCUMENT TO THESE DRAWINGS. RESOLUTION OF ANY INCONSISTENCIES BETWEEN THESE DRAWINGS AND THE ADOPTED SPECIFICATIONS WILL BE MADE BY THE CITY ENGINEER.

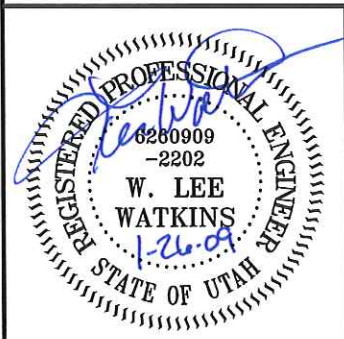

APPROVED  
  
 W. LEE WATKINS  
 CITY CONSULTING ENGINEER  
 DATE 1-26-09

APPROVED  
 \_\_\_\_\_  
 HONEYVILLE CITY MAYOR  
 DATE \_\_\_\_\_

**HANSEN & ASSOCIATES, INC.**  
 Consulting Engineers and Land Surveyors  
 538 North Main Brigham City, Utah 84302  
 Brigham City Ogden Logan  
 723-3491 399-4905 752-8272

REVISION DATE:  
 DATE: 1/23/09  
 SCALE: NONE

HONEYVILLE CITY  
 PUBLIC WORKS CONSTRUCTION STANDARDS  
**STORM DRAIN DETAILS**

SHEET:  
**11**  
 OF 13 SHEETS



N:\Details\City Standards\08-30-12 Honeyville\Honeyville Town Standards.dwg, Sheet12, 1/26/2009 11:10:09 AM, 1:10

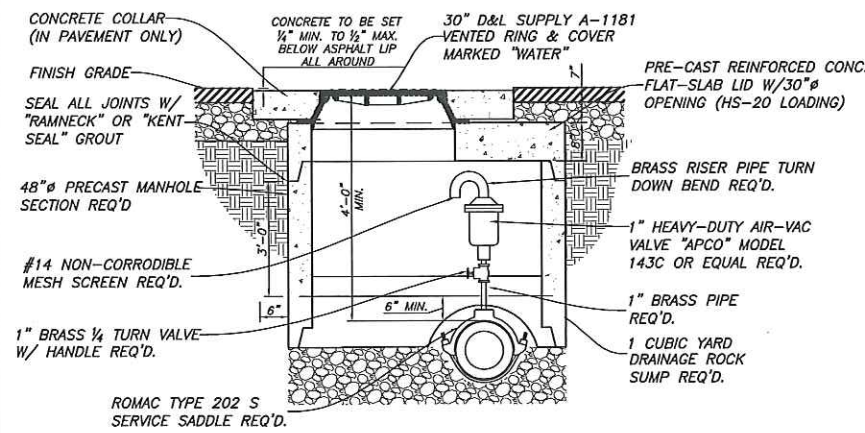

TYPICAL FLUSH VALVE CONNECTION

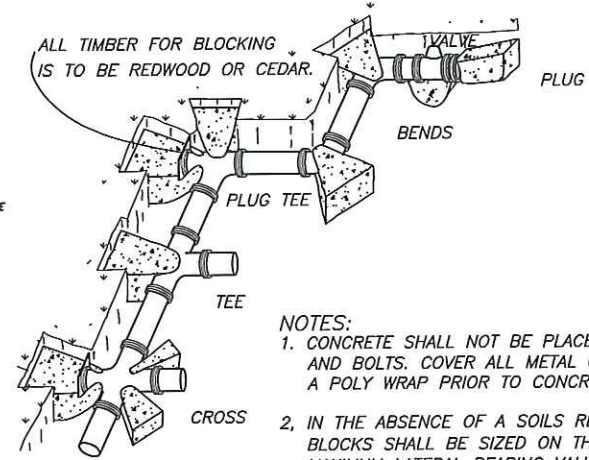
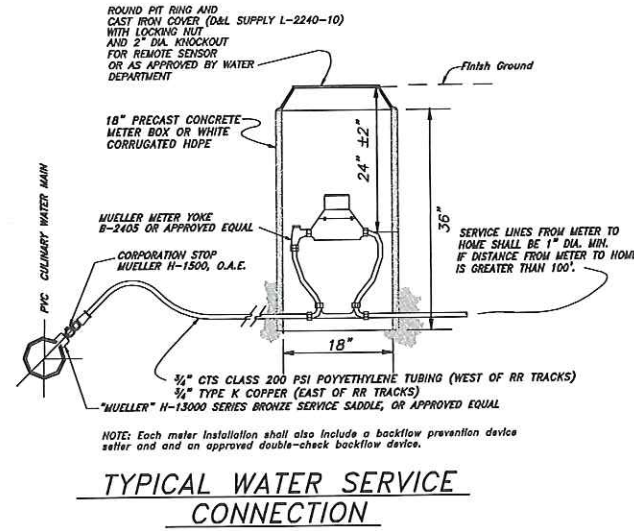

- NOTES:
- CONCRETE SHALL NOT BE PLACED AROUND JOINTS AND BOLTS. COVER ALL METAL CONTACT AREAS WITH A POLY WRAP PRIOR TO CONCRETE PLACEMENT.
  - IN THE ABSENCE OF A SOILS REPORT, ALL THRUST BLOCKS SHALL BE SIZED ON THE BASIS OF A MAXIMUM LATERAL BEARING VALUE OF 800 P.S.F. AND A THRUST RESULTING FROM 150% OF THE WATERLINE STATIC PRESSURE.
  - THRUST BLOCKS SHALL BE CONSTRUCTED AT ALL BENDS OF 22 1/2 DEGREES AND GREATER AND BEHIND ALL TEES, FIRE HYDRANTS, AND PLUGS. THEY SHALL BE CONSTRUCTED OF 2000 P.S.I. CONCRETE OR BETTER.

THRUST BLOCKING DETAIL

AIR RELEASE STATION FOR 4' BURY WATERLINE

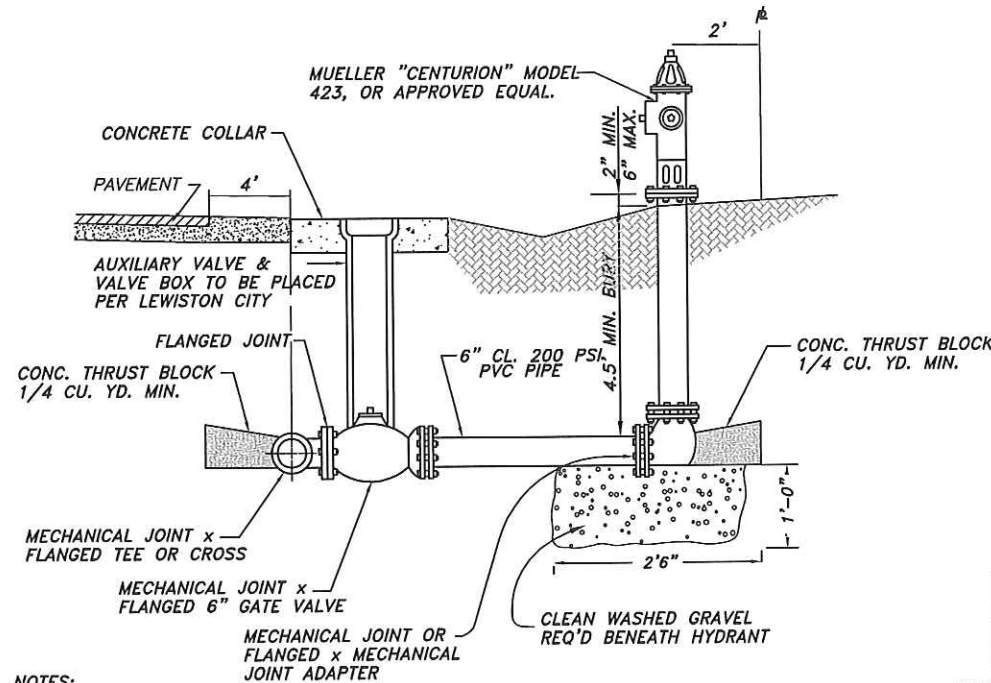
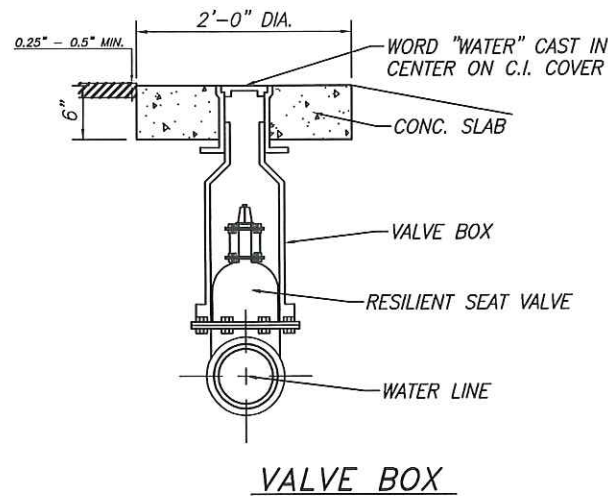

- NOTES:
- MECHANICAL FITTINGS WITH A MINIMUM OF TWO "ALL THREAD" BOLTS PER CONNECTION MAY BE USED IN LIEU OF THE FLANGED FITTINGS SHOWN.
  - FIRE HYDRANTS SHALL BE SPACED AT A MAXIMUM INTERVAL OF 500 FT., OR SO THAT EVERY RESIDENCE IN THE DEVELOPMENT IS WITHIN 250 FT. OF A FIRE HYDRANT.
  - FIRE HYDRANT SHALL HAVE A NOMINAL VALVE OPENING OF 5 1/4" DIA.

TYPICAL FIRE HYDRANT INSTALLATION

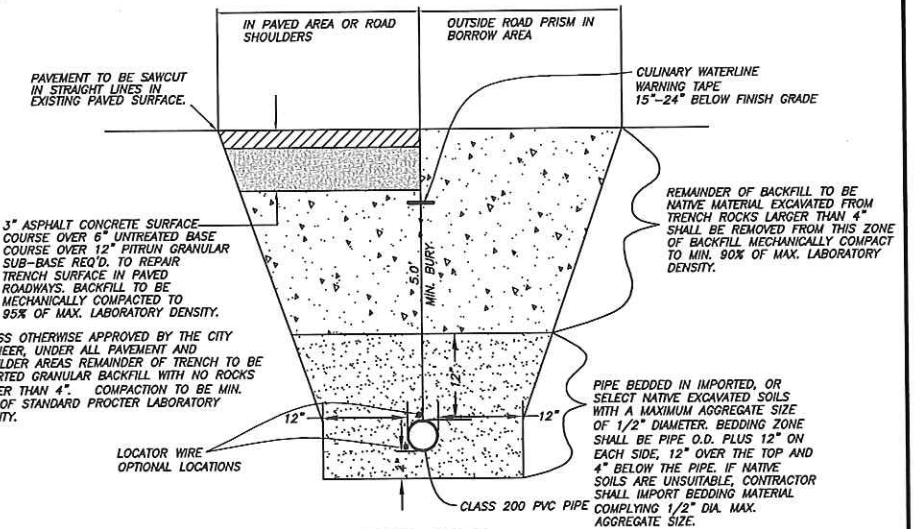

PVC PIPE BEDDING AND BACKFILL DETAIL

CONSTRUCTION REQUIREMENTS: WHERE APPLICABLE, AND UNLESS OTHERWISE SPECIFIED, CONSTRUCTION OF PUBLIC WORKS FACILITIES AND INFRASTRUCTURE SHALL COMPLY WITH THE LATEST EDITION OF THE AMERICAN PUBLIC WORKS ASSOCIATION MANUAL OF STANDARD SPECIFICATIONS WHICH ARE ADOPTED BY REFERENCE AS A COMPANION DOCUMENT TO THESE DRAWINGS. RESOLUTION OF ANY INCONSISTENCIES BETWEEN THESE DRAWINGS AND THE ADOPTED SPECIFICATIONS WILL BE MADE BY THE CITY ENGINEER.

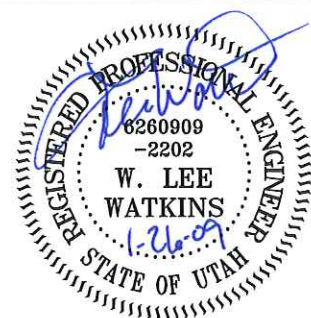

W. LEE WATKINS  
 1-26-09  
 CITY CONSULTING ENGINEER DATE

APPROVED  
 HONEYVILLE CITY MAYOR DATE

HANSEN & ASSOCIATES, INC.  
 Consulting Engineers and Land Surveyors  
 538 North Main Brigham City, Utah 84302  
 Brigham City Ogden Logan  
 723-3491 399-4905 752-8272

REVISION DATE:  
 DATE: 1/23/09  
 SCALE: NONE

HONEYVILLE CITY  
 PUBLIC WORKS CONSTRUCTION STANDARDS  
**CULINARY WATER SYSTEM  
 STANDARD DETAILS**

SHEET:  
**12**  
 OF 13 SHEETS



- METER PLACEMENT:
  - IN NEW CONSTRUCTION, INSTALL METER AT CENTER OF LOT OR PER AGENCY REQUIREMENTS.
  - ALL METERS ARE TO BE INSTALLED IN THE PARK STRIP OR WITHIN 7 FEET OF THE PROPERTY LINE (STREET SIDE).
  - DO NOT INSTALL METERS UNDER DRIVEWAY APPROACHES, SIDEWALKS, OR CURB & GUTTER.
- PIPE: INSTALL TYPE 'K' COPPER PIPE TO PROPERTY LINE. COORDINATE WITH UTILITY AGENCY FOR TYPE OF PIPE TO BE USED OUTSIDE OF RIGHT-OF-WAY.
- ALTERNATE: TURBINE METERS ARE REQUIRED ON ALL SYSTEMS USED EXCLUSIVELY FOR IRRIGATION OR FIRE PROTECTION. WHERE DOMESTIC USE IS APPLICABLE, USE A STANDARD METER.
- BYPASS VALVE: LOCK IN OFF POSITION.
- BLOCKING: USE CLAY BRICK OR CONCRETE BLOCK.
- CONCRETE BOX:
  - CENTER FRAME AND COVER OVER WATER METER.
  - ALLOW 1 INCH CLEARANCE AROUND WATERLINE WHERE LINE PASSES THROUGH WALL. SEAL OPENING WITH COMPRESSIBLE SEAL.
- INSPECTION: PRIOR TO BACKFILLING AROUND THE METER BOX, SECURE INSPECTION OF INSTALLATION BY ENGINEER.
- BACKFILL: PROVIDE AND PLACE PER APWA SECTION 02321. COMPACT PER APWA SECTION 02324 TO A MODIFIED PROCTOR DENSITY OF 95% OR GREATER. MAXIMUM LIFT THICKNESS IS 8" BEFORE COMPACTION.

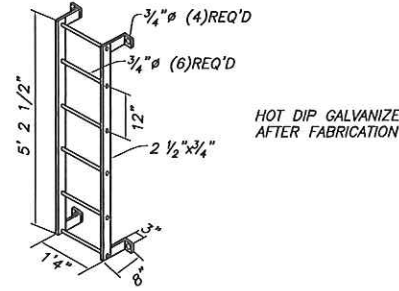

LADDER DETAIL

PIPE & FITTING SCHEDULE					
NO.	DESCRIPTION	TYPE	3" LINE	4" LINE	6" LINE
1	SENSUS W-350DR METER W/STRAINER (SEE NOTE 1)	FL	3"	-	-
2	SENSUS W-100DR METER W/STRAINER (SEE NOTE 1)	FL	-	4"	-
3	SENSUS W-200DR METER W/STRAINER (SEE NOTE 1)	FL	-	-	6"
4	RESILIENT SEAT GATE VALVE W/HANDWHEEL	FLxFL	3"	-	-
5	RESILIENT SEAT GATE VALVE W/HANDWHEEL	FLxFL	4"	4"	6"
6	ROMAC FD401 FLANGED COUPLING ADAPTER	FLxPE	3"	4"	6"
7	ROMAC D400 DISMANTLING JOINT	FLxFL	3"	4"	6"
8	TEE	FL	3"	4"	6"
9	90° ELBOW	FL	3"	4"	6"
10	SPOOL PIECE	FLxPE	3"x30"	4"x30"	6"x30"
11	SPOOL PIECE	FLxFL	3"x31"	4"x29"	6"x26"
12	SPOOL PIECE	FLxPE	3"x12"	4"x12"	6"x12"
13	SPOOL PIECE	FLxPE	3"x56"	4"x56"	6"x54 1/2"
14	SPOOL PIECE	FLxPE	3"x56"	4"x56"	6"x54 1/2"
15	ROMAC 501 FLEXIBLE PIPE COUPLING	FLxPE	3"x23"	4"x26 1/2"	6"x22 3/4"
16	ROMAC MJRG MECHANICAL JOINT RETAINER GLAND		3"	4"	6"
17	3"x4" REDUCER	FLxFL	3"	4"	-

NOTE 1: OR OTHER METER BRAND PER COMMUNITY WATER DEPARTMENT

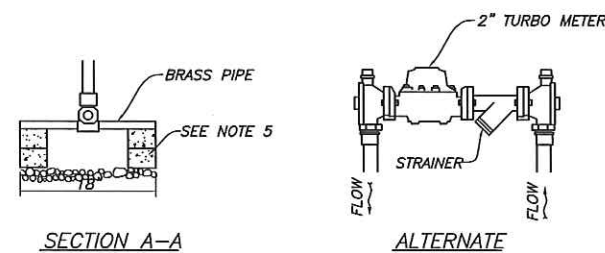
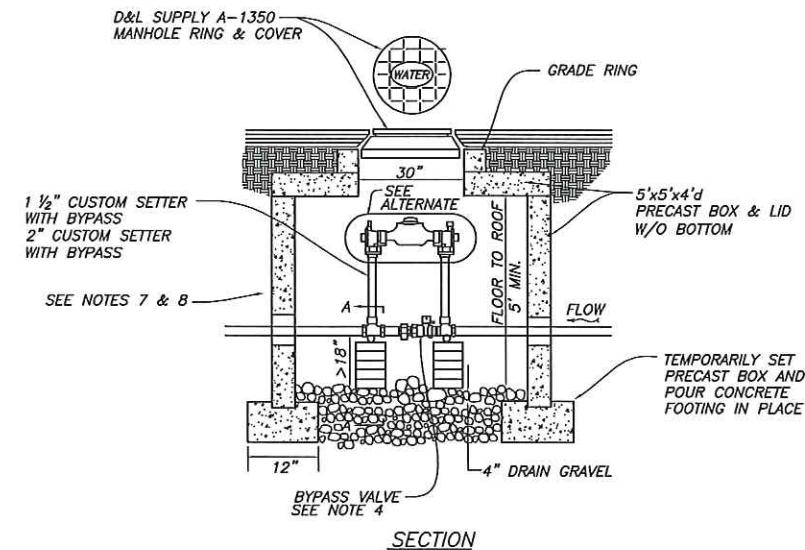
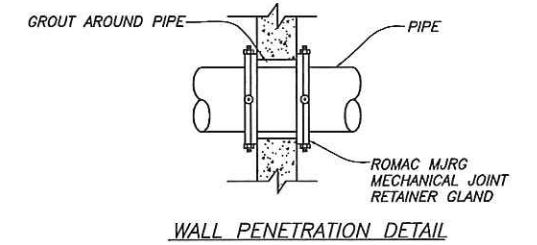

1 1/2" AND 2" METER

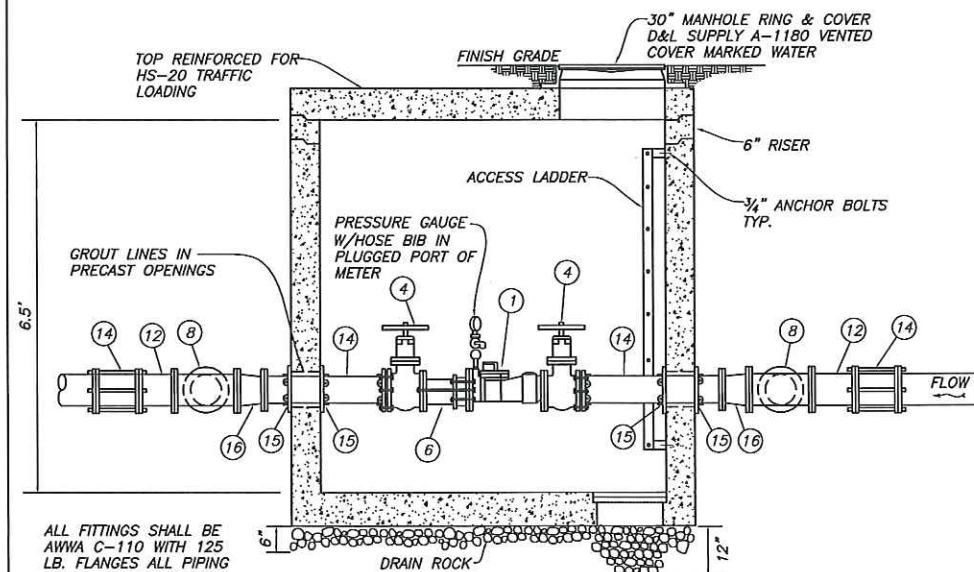
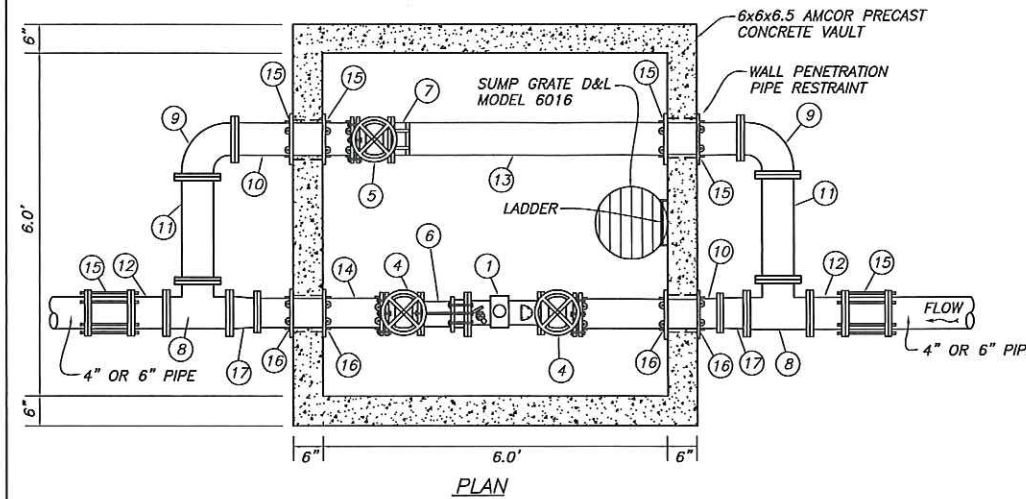

ALL FITTINGS SHALL BE AWWA C-110 WITH 125 LB. FLANGES ALL PIPING SHALL BE DUCTILE IRON PIPE CLASS 350 PSI MIN.

3" WATER METER STATION

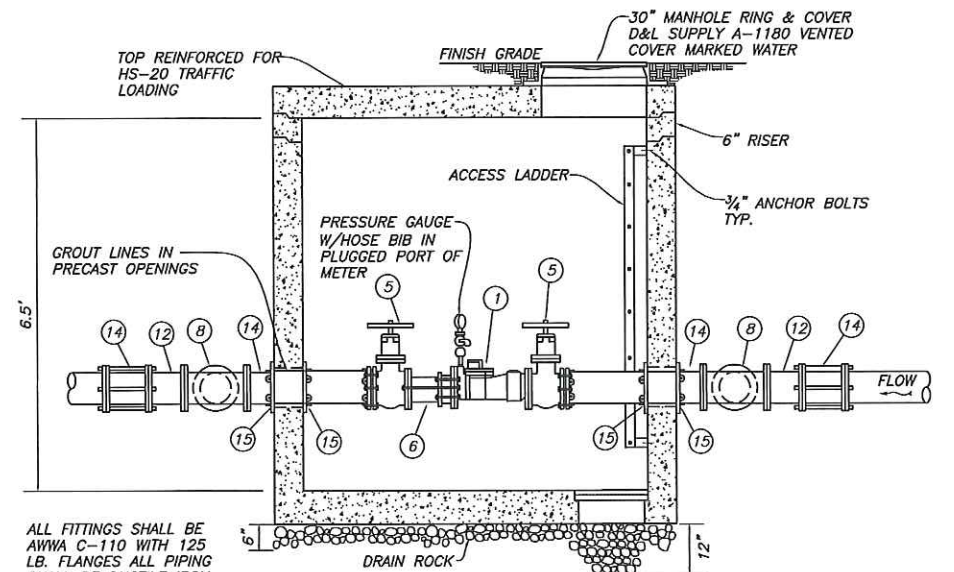
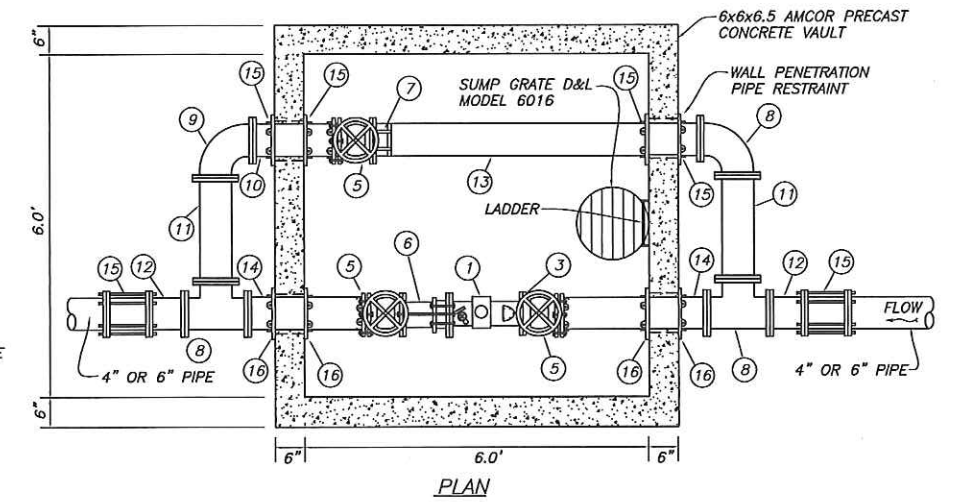

ALL FITTINGS SHALL BE AWWA C-110 WITH 125 LB. FLANGES ALL PIPING SHALL BE DUCTILE IRON PIPE CLASS 350 PSI MIN.

4" & 6" WATER METER STATION

CONSTRUCTION REQUIREMENTS: WHERE APPLICABLE, AND UNLESS OTHERWISE SPECIFIED, CONSTRUCTION OF PUBLIC WORKS FACILITIES AND INFRASTRUCTURE SHALL COMPLY WITH THE LATEST EDITION OF THE AMERICAN PUBLIC WORKS ASSOCIATION MANUAL OF STANDARD SPECIFICATIONS WHICH ARE ADOPTED BY REFERENCE AS A COMPANION DOCUMENT TO THESE DRAWINGS. RESOLUTION OF ANY INCONSISTENCIES BETWEEN THESE DRAWINGS AND THE ADOPTED SPECIFICATIONS WILL BE MADE BY THE CITY ENGINEER.

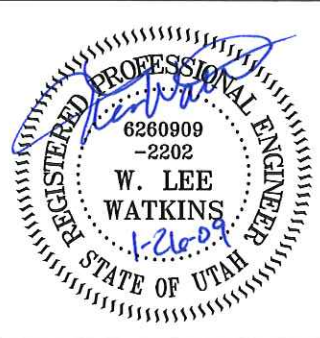

APPROVED  
  
 W. LEE WATKINS  
 CITY CONSULTING ENGINEER  
 DATE 1-26-09

APPROVED  
 HONEYVILLE CITY MAYOR  
 DATE

HANSEN & ASSOCIATES, INC.  
 Consulting Engineers and Land Surveyors  
 538 North Main Brigham City, Utah 84302  
 Brigham City Ogden Logan  
 723-3491 399-4905 752-8272

REVISION DATE:  
 DATE: 1/23/09  
 SCALE: NONE

HONEYVILLE CITY  
 PUBLIC WORKS CONSTRUCTION STANDARDS  
**LARGE DIAMETER SERVICE  
 METER DETAILS**

SHEET:  
**13**  
 OF 13 SHEETS